



**TEKIRO**  
75 ton Hydraulic Jack

**CAUTION**

- Always support the load evenly
- Do not use the jack on uneven or soft surfaces
- Do not use the jack on any surface that is not rated for the load
- Do not use the jack on any surface that is not rated for the load
- Do not use the jack on any surface that is not rated for the load

TEKIRO CE



**AUTOMOTIVE**



## MACHINE BLOCK WRENCH 17 X 24 MM

### KUNCI BLOK MESIN 17 X 24 MM

- Material chrome vanadium
- Highly durable
- Easy to use
- Corrosion resistance



ITEM CODE	SIZE	1 (mm)	2 (mm)	3 (mm)	4 (mm)	5 (mm)	6 (mm)	7 (mm)	WEIGHT (gr)	QTY / BOX INNER/MASTER
AU-MB0959	LURUS	235	24	17	41	35	25	6	255	6 / 60 pcs
AU-MB0960	BENGKOK	250	17	24	35	42	16	5	255	6 / 60 pcs

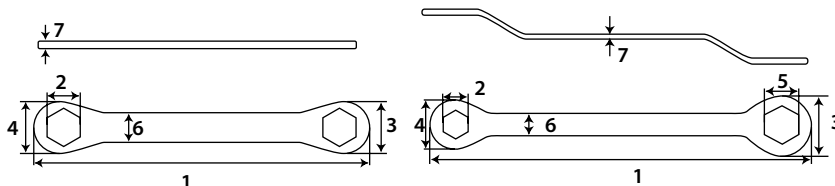

## OIL FILTER WRENCH (CHAIN)

### KUNCI OIL FILTER (RANTAI)

- Heat treated alloy steel
- Drop forged for extra strength
- High quality powder coating finish



ITEM CODE	SIZE	1 (mm)	2 (mm)	3 (mm)	4 (mm)	5 (mm)	6 (mm)	WEIGHT (gr)	QTY / BOX INNER/MASTER
AU-OF0961	6"	415	160	17	18	4	4	407	6 / 48 pcs
AU-OF0962	9"	500	230	24	21	5	9	419	6 / 48 pcs

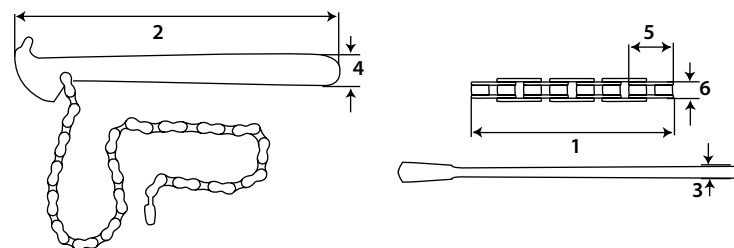

## OIL FILTER WRENCH (BELT)

### KUNCI OIL FILTER (KULIT)

- Heat treated alloy steel
- Drop forged for extra strength
- High quality powder coating finish



ITEM CODE	SIZE	1 (mm)	2 (mm)	3 (mm)	4 (mm)	5 (mm)	6 (mm)	WEIGHT (gr)	QTY / BOX INNER/MASTER
AU-OF0963	9"	520	229	10	20	23	19	310	12 / 72 pcs

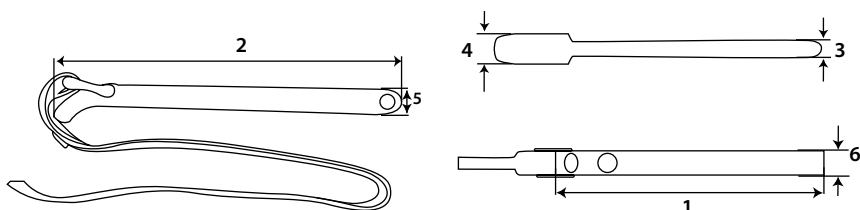



## OIL FILTER (BOWL)

### KUNCI OIL FILTER (MANGKOK)

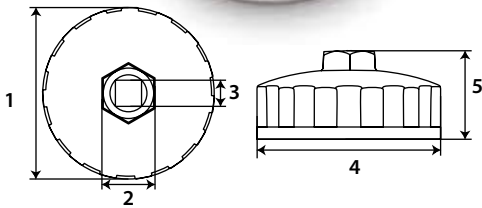

ITEM CODE	SIZE	1 (mm)	2 (mm)	3 (mm)	4 (mm)	5 (mm)	WEIGHT (gr)	QTY / BOX INNER/MASTER
AU-OF0964	64 mm	72	26	26	72	35	77	12 / 100 pcs
AU-OF1468	66.5 mm	76	26	26	73	34	82	12 / 120 pcs
AU-OF1469	72.5 mm	78	26	26	78	36	80	12 / 120 pcs
AU-OF0965	74 mm	80	26	26	81	35	90	12 / 120 pcs
AU-OF0966	79 mm	79	26	26	85	42	109	12 / 120 pcs
AU-OF0967	89 mm	95	26	26	96	41	112	12 / 120 pcs
AU-OF0968	99 mm	106	26	26	106	46	138	12 / 120 pcs

#### Keterangan

64 mm = Avanza, CRV Lama, City

66.5 mm = Xenia

72.5 mm = Innova

74 mm = BMW, VW, Audi, Opel, Harley, Innova

79 mm = Kijang Kapsul, Taruna, Feroza, Ford

89 mm = Civic, Mitsubishi, Panther Lama

99 mm = Colt Diesel, Panther

## 2 WAY OIL FILTER

### KUNCI OIL FILTER 2 ARAH

- Material Chrome Vanadium
- Remove and install Oil filter easily and quickly
- Hold the oil filter simply and firmly
- Suitable for 1/2" and 3/8" DR. Ratchet handle



ITEM CODE	SIZE	1 (mm)	2 (mm)	WEIGHT (gr)	QTY / BOX INNER/MASTER
AU-OF0969	63 -102 mm	22	14	377	1 / 48 pcs

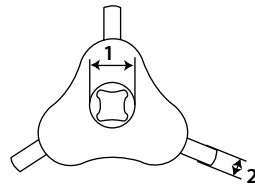

- High quality plastic
- Elastic cable
- Indicator lamp for easy check



## AUTO VOLTAGE TESTER

ITEM CODE	SIZE	WEIGHT (gr)	QTY / BOX INNER/MASTER
AU-VT1061	DC	377	12 / 120 pcs

- Material Chrome Vanadium
- Heat treated Chrome vanadium steel
- Drop forged for extra strenght
- Silver matt finish

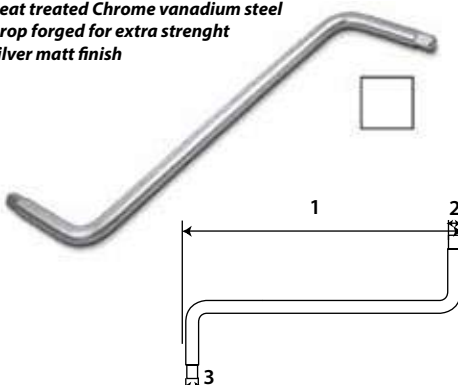

## DRAIN PLUG WRENCH

### KUNCI OLI GANDA

ITEM CODE	SIZE	1 (mm)	2 (mm)	3 (mm)	WEIGHT (gr)	QTY / BOX INNER/MASTER
AU-DP0970	8 X 10 mm	280	8	10	347	12 / 60 pcs
AU-DP0971	10 X 10 mm	271	10	10	345	12 / 60 pcs



## WHEEL NUT WRENCH (BLACK)

### KUNCI RODA HITAM

- CRV head socket
- High durable rusty painting



ITEM CODE	SIZE	1 (mm)	2 (mm)	3 (mm)	4 (mm)	WEIGHT (gr)	QTY / BOX INNER/MASTER
AU-WN0972	10 mm	255	71	10	12	326	6 / 48 pcs
AU-WN0973	12 mm	256	74	12	12	349	6 / 48 pcs
AU-WN0974	14 mm	245	78	14	13	358	6 / 48 pcs

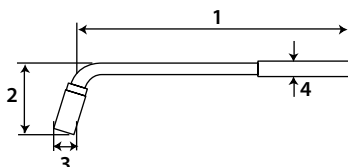

## WHEEL MASTER

### KUNCI RODA TARIK

- Heavy duty and durable quality
- Telescopic handle for overstanding leverage
- Non-slip handgrip for comfortable holding



ITEM CODE	SIZE	1 (mm)	2 (mm)	3 (mm)	4 (mm)	5 (mm)	6 (mm)	WEIGHT (gr)	QTY / BOX INNER/MASTER
AU-WM0975	19 X 21 mm	335	90	110	19	29	20	885	1 / 24 pcs

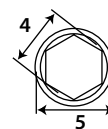
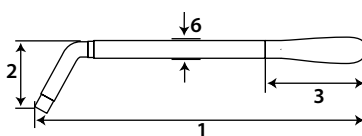

## WHEEL NUT WRENCH FOR TRUCK

### KUNCI RODA TRUK

- Molybdenum materials
- CRV head socket
- High durable rusty painting



ITEM CODE	SIZE	1 (mm)	2 (mm)	3 (mm)	4 (mm)	5 (mm)	WEIGHT (gr)	QTY / BOX INNER/MASTER
AU-WN1461	20 X 38 X 440 mm	595	37	55	435	37	3,454	8 pcs
AU-WN1462	21 X 41 X 440 mm	595	39	39	440	39	3,844	8 pcs

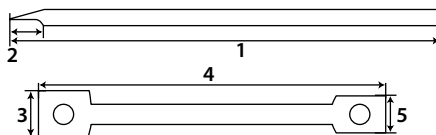

## 4 WAY CROSS WRENCH 14"

### KUNCI RODA PALANG 14"

- CRV head socket
- High durable rusty painting



ITEM CODE	SIZE	1 (mm)	2 (mm)	3 (mm)	4 (mm)	WEIGHT (gr)	QTY / BOX INNER/MASTER
AU-WC1463	17 X 19 X 21 X 23 mm	353	23	26 - 28 - 30 - 30	35	1,204	1 / 10 pcs

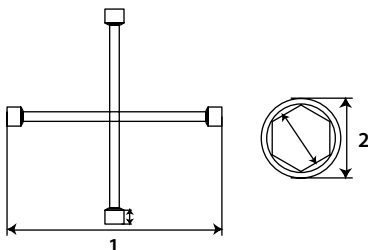



## WHEEL NUT WRENCH

### KUNCI RODA L

- Material Chrome Vanadium
- CRV head socket
- High durable rusty painting



ITEM CODE	SIZE	1 (mm)	2 (mm)	3 (mm)	4 (mm)	5 (mm)	6 (mm)	WEIGHT (gr)	QTY / BOX INNER/MASTER
AU-WN0976	19 mm	298	95	27	20	28	15	529	12 / 24 pcs
AU-WN0977	21 mm	300	95	27	21	30	15	510	12 / 24 pcs

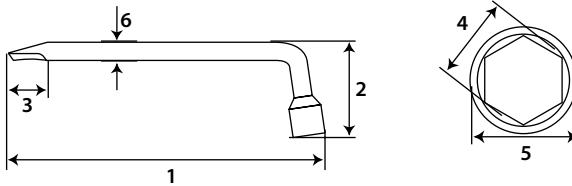

## FEELER GAUGE

- Material Chrome Vanadium
- Complete range size
- Longer leaves allow accurate measuring



ITEM CODE	SIZE	1 (mm)	2 (mm)	3 (mm)	4 (mm)	5 (mm)	6 (mm)	WEIGHT (gr)	QTY / BOX INNER/MASTER
AU-FG1292	13 blades	106	13	8	100	14	16	57	1 / 120 pcs

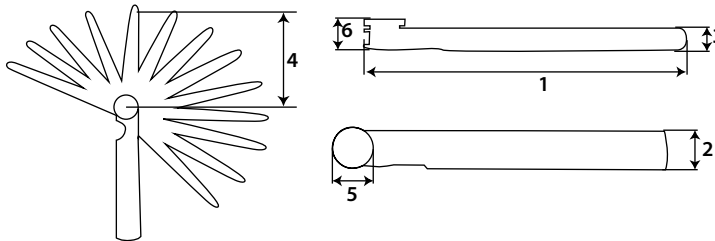

## FEELER GAUGE ROLL

- High quality zinc
- Corrosion resistance
- Precision thickness

ITEM CODE	SIZE	1 (mm)	2 (mm)	3 (mm)	WEIGHT (gr)	QTY / BOX INNER/MASTER
AU-FG1293	0.02 MM X 13 X 5	5,000	18	94	40	1 / 100 pcs
AU-FG1294	0.03 MM X 13 X 5	5,000	18	94	47	1 / 100 pcs
AU-FG1295	0.04 MM X 13 X 5	5,000	18	94	51	1 / 100 pcs
AU-FG1296	0.05 MM X 13 X 5	5,000	18	94	60	1 / 100 pcs
AU-FG1297	0.06 MM X 13 X 5	5,000	18	94	61	1 / 100 pcs
AU-FG1298	0.07 MM X 13 X 5	5,000	18	94	65	1 / 100 pcs
AU-FG1299	0.08 MM X 13 X 5	5,000	18	94	70	1 / 100 pcs
AU-FG1300	0.09 MM X 13 X 5	5,000	18	94	61	1 / 100 pcs
AU-FG1301	0.10 MM X 13 X 5	5,000	18	94	85	1 / 100 pcs



## TIRE GAUGE (SMALL)

### UKURAN TEKANAN ANGIN (KECIL)

• Material Chrome Vanadium



ITEM CODE	SIZE	1 (mm)	2 (mm)	3 (mm)	4 (mm)	WEIGHT (gr)	QTY / BOX INNER/MASTER
AU-TG0980	60 lb	220	142	10	8	38	50 / 250 pcs
AU-TG0981	120 lb	220	142	10	8	40	50 / 250 pcs



## TIRE GAUGE (BIG)

### UKURAN TEKANAN ANGIN (BESAR)

• Material Chrome Vanadium



ITEM CODE	SIZE	1 (mm)	2 (mm)	3 (mm)	4 (mm)	5 (mm)	6 (mm)	7 (mm)	WEIGHT (gr)	QTY / BOX INNER/MASTER
AU-TG0982	# 7 (160 psi)	272	10	27	14	8	372	15	120	10 / 100 pcs
AU-TG0983	# 9 (200 psi)	272	10	27	14	8	372	15	140	10 / 100 pcs

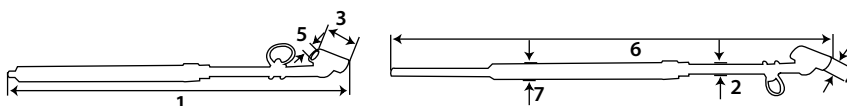

## AIR CHUCK 6"

### ISI ANGIN (KECIL)

• Material Chrome Vanadium

- Dual head pump up
- Hanging hole design
- Air inflow enlarge



ITEM CODE	SIZE	1 (mm)	2 (mm)	3 (mm)	WEIGHT (gr)	QTY / BOX INNER/MASTER
AU-AC0984	Chrome 6"	170	9	15	115	10 / 100 pcs

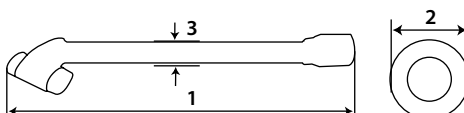

## TUNE UP KIT 5 PCS

ITEM CODE
5 PCS
AU-TU1060

- Flexible ratchet handle for flexible working
- Extension bar to reach deep position
- High corrosion resistance

SIZE	CONTENT	WEIGHT (gr)	QTY / BOX INNER/MASTER
5 pcs	1 pcs 3/8" DR. Ratchet Handle Flexible	940	1 / 20 set
	1 pcs 3/8" Spark Plug Socket 16 mm		
	1 pcs 3/8" Spark Plug Socket 21 mm		
	1 pcs 3/8" DR. Extension Bar 5"		
	1 pcs 3/8" DR. Extension Bar 8"		





## TIRE PRESSURE GAUGE 3 IN 1

ISI ANGIN 3 FUNGSI

- Ergonomic handle
- Flexible & high pressure hose
- Material Chrome vanadium
- Measuring, decreasing, increasing air pressure in car tires



ITEM CODE	SIZE	1 (mm)	2 (mm)	3 (mm)	4 (mm)	5 (mm)	6 (mm)	WEIGHT (gr)	QTY / BOX INNER/MASTER
AU-PG1405	200 psi	125	11	75	13	12	515	450	1 / 40 pcs

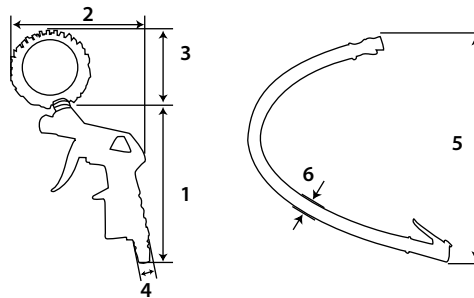

## TIRE PRESSURE GAUGE

UKURAN ANGIN BULAT

- Angle chuck model
- Large dial for easy to read
- Suitable for most tire
- Measuring air pressure in car tires



ITEM CODE	SIZE	1 (mm)	2 (mm)	WEIGHT (gr)	QTY / BOX INNER/MASTER
AU-TG1670	60 psi	48	100	113	10 / 100 pcs

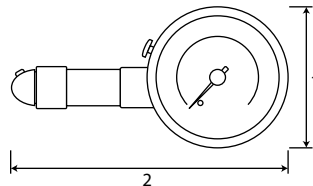

## PRESSURE GAUGE

UKURAN TEKAPAN 2.5"

- Double standard air pressure
- Glass cover
- Measuring air pressure in application compressor



ITEM CODE	SIZE	1 (mm)	2 (mm)	3 (mm)	WEIGHT (gr)	QTY / BOX INNER/MASTER
AU-PG1395	2.5 bar	61	26	12	109	10 / 100 pcs
AU-PG0986	4 bar	61	28	13	120	10 / 100 pcs
AU-PG0987	6 bar	61	28	13	120	10 / 100 pcs
AU-PG0988	10 bar	61	28	13	120	10 / 100 pcs
AU-PG0989	16 bar	61	28	13	120	10 / 100 pcs
AU-PG0990	25 bar	61	28	13	120	10 / 100 pcs

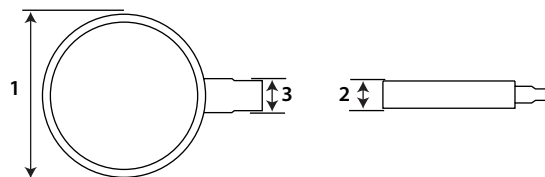



# TEKIRO®



SCREWDRIVER



AUTOMOTIVE



STORAGE



TRAY



## HYDRAULIC FLOOR JACK WITH CASE 2 TON SPEC #2 DONGKRAK BUAYA 2 TON SPEC #2

- 360° rotating lifting handle
- Maximal lifting height : 342mm
- Safety valve to ensure the safety

ITEM CODE	SIZE	1 (mm)	2 (mm)	3 (mm)	4 (mm)	5 (mm)	6 (mm)	7 (mm)	WEIGHT (gr)	QTY / BOX INNER/MASTER
AU-FJ0995	2 ton	440	200	135	52	135 - 335	458	335	8,177	1 pcs

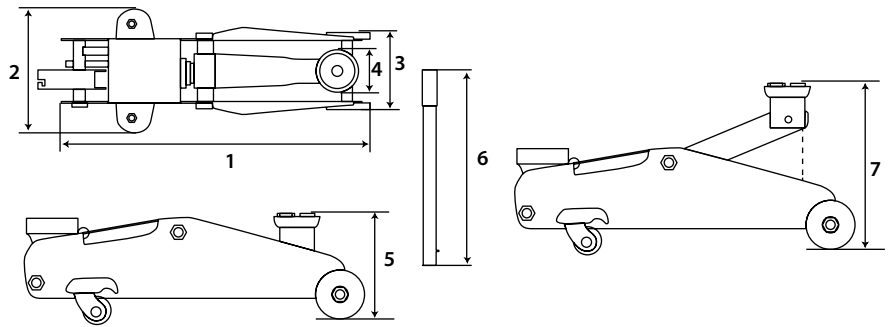

## FLOOR JACK TYPE ROTARY DONGKRAK BUAYA PUTAR

- High durable hardness
- Quick lifting weight
- Rotary type movement

ITEM CODE	SIZE	1 (mm)	2 (mm)	3 (mm)	4 (mm)	5 (mm)	6 (mm)	7 (mm)	WEIGHT (gr)	QTY / BOX INNER/MASTER
AU-FJ0995	2 ton	440	200	135	52	135 - 335	458	335	8,274	1 pcs

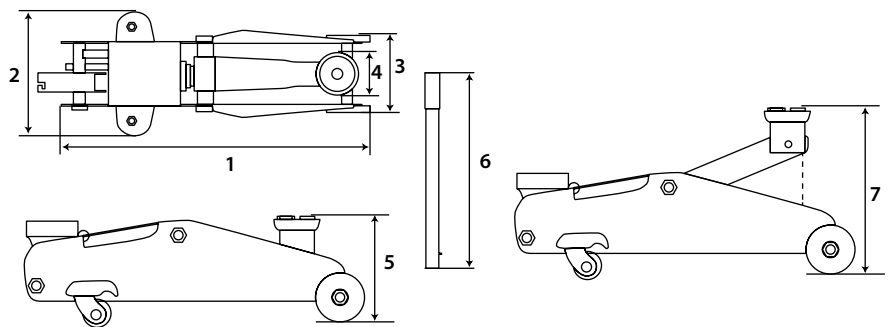

## HEAVY DUTY HYDRAULIC FLOOR JACK DONGKRAK BUAYA PANJANG

- Wide bowl for stability
- Foot pump for high speed lifting
- Safety valve to prevent Over load

ITEM CODE	SIZE	1 (mm)	2 (mm)	3 (mm)	4 (mm)	5 (mm)	6 (mm)	7 (mm)	8 (mm)	WEIGHT (gr)	QTY / BOX INNER/MASTER
AU-FJ0997	3 ton	1,140	300	235	78	300	110	89	560	34,000	1 pcs
AU-FJ0998	5 ton	1,301	360	270	130	300	110	109	560	87,000	1 pcs
AU-FJ0999	10 ton	1,360	480	320	180	370	170	141	560	133,000	1 pcs

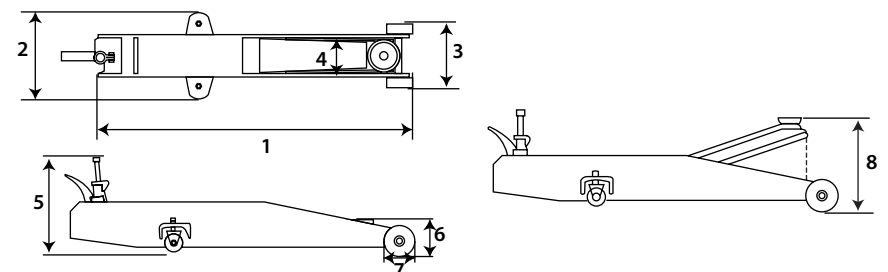





# TEKIRO®



## ALUMINUM FLOOR JACK DONGKRAK BUAYA ALUMINIUM

- Aluminum material
- Quick lifting weight
- Lifting stability
- Durable, lightweight steel & alluminium construction



ITEM CODE	SIZE	1 (mm)	2 (mm)	3 (mm)	4 (mm)	5 (mm)	6 (mm)	7 (mm)	WEIGHT (gr)	QTY / BOX INNER/MASTER
AU-FJ1000	3000 LBS (1.5 Ton)	510	240	135	100	200	83	370	11,200	1 pcs

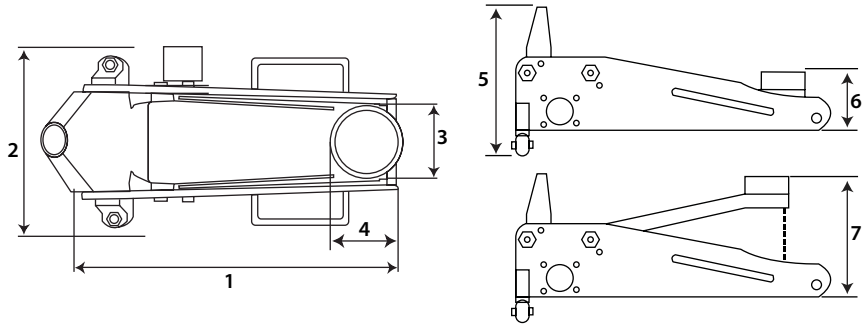

## HYDRAULIC JACK DOUBLE PUMP LOW PROFILE DONGKRAK BUAYA 3 TON CEPER

- High durable hardness
- Quick lifting weight
- Wide bowl for stability
- Compact design for sample use
- Roller action design
- Double pump technologi for high speed lifting
- Low profile design works for most vehicles with 3 1/2" ground clearance



ITEM CODE	SIZE	1 (mm)	2 (mm)	3 (mm)	4 (mm)	5 (mm)	6 (mm)	7 (mm)	WEIGHT (gr)	QTY / BOX INNER/MASTER
AU-FJ1677	3 Ton	650	330	253	109	60	42.3	528	3,400	1 / 1 pcs

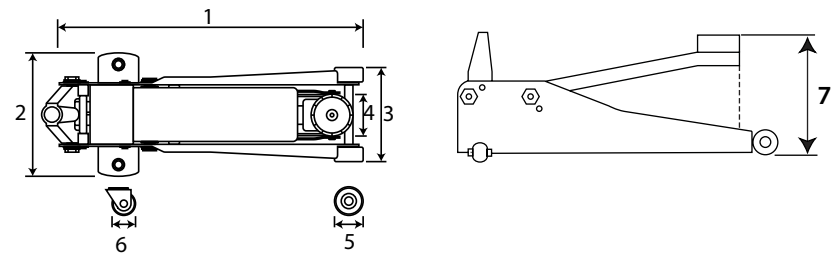

## SCISSOR JACK AUTOMOTIVE DONGKRAK JEMBATAN 2 TON

- Thread rod is integral rod
- Arms have teeth design increase stabilization
- Handle is riveted together can be folded, easy to carry
- Comes with handle



ITEM CODE	SIZE	1 (mm)	2 (mm)	3 (mm)	4 (mm)	5 (mm)	6 (mm)	WEIGHT (gr)	QTY / BOX INNER/MASTER
AU-SJ1059	2 ton	440	68	165	29	60	560	3,360	1 pcs

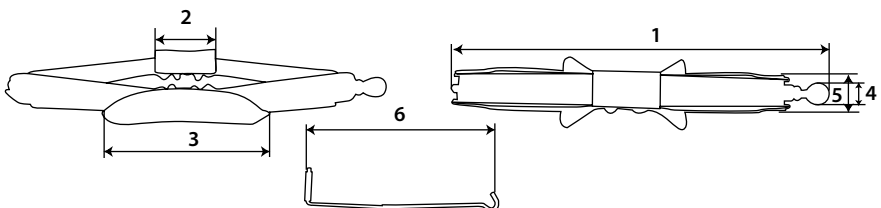

SCREWDRIVER



AUTOMOTIVE



STORAGE



TRAY





## HYDRAULIC BOTTLE JACK

### DONGKRAK BOTOL

- High durable hardness
- Quick lifting weight
- Stable lifting



ITEM CODE	SIZE	1 (mm)	2 (mm)	3 (mm)	4 (mm)	5 (mm)	6 (mm)	7 (mm)	WEIGHT (gr)	QTY / BOX INNER/MASTER
AU-BJ1001	2 ton	355	126	185	15	23	51	7	2,400	1 / 6 pcs
AU-BJ1002	4 ton	390	132	199	19	28	60	8	3,130	1 / 6 pcs
AU-BJ1003	6 ton	450	152	220	23	32	70	9	4,500	1 / 4 pcs
AU-BJ1004	10 ton	475	165	235	27	40	80	9	6,800	1 / 4 pcs
AU-BJ1005	15 ton	475	161	245	32	48	95	9	8,300	1 / 2 pcs
AU-BJ1006	20 ton	475	170	254	35	53	114	10	11,000	1 / 2 pcs
AU-BJ1007	30 ton	485	200	285	50	67	136	44	21,480	1 pcs
AU-BJ1008	50 ton	500	200	300	70	82	158	44	31,960	1 pcs
AU-BJ1009	100 ton	540	215	325	100	115	230	55	87,000	1 pcs

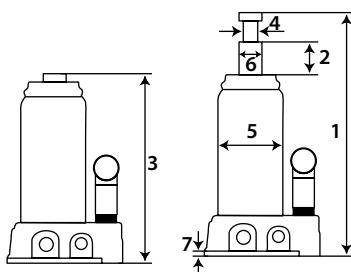

## JACK STAND

### TAHANAN DONGKRAK

- Large feet area & large saddle for stabilization
- double locking protection for safety

ITEM CODE	SIZE	1 (mm)	2 (mm)	3 (mm)	4 (mm)	5 (mm)	6 (mm)	7 (mm)	WEIGHT (gr)	QTY / BOX INNER/MASTER
AU-JS1010	3 ton	288	423	210	64	270	35	26	6,930	1 / 4 pcs
AU-JS1011	6 ton	400	615	290	70	365	40	29	130,003	1 pcs

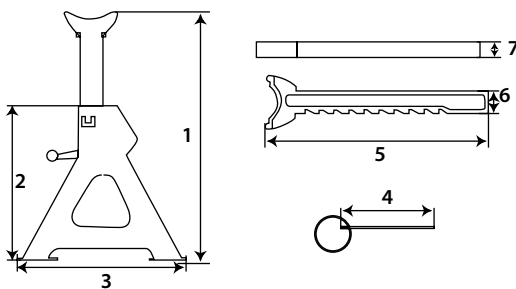

## HAND GREASE GUN

### POMPA GEMUK - TANGAN

- High pressure flexible hose
- Very high pressure steel tube
- It can be used in narrow space



ITEM CODE	SIZE	1 (mm)	2 (mm)	3 (mm)	4 (mm)	5 (mm)	6 (mm)	WEIGHT (gr)	QTY / BOX INNER/MASTER
AU-GG1015	500 cc	379	58	17	266	68	90	1,501	12 pcs

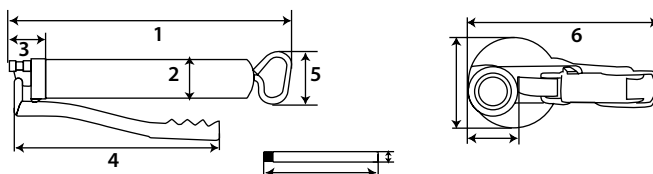



## MINI GREASE GUN

### POMPA GEMUK MINI TANGAN

- Small size, high pressure
- Special coupler

ITEM CODE	SIZE	1 (mm)	2 (mm)	3 (mm)	4 (mm)	5 (mm)	6 (mm)	7 (mm)	WEIGHT (gr)	QTY / BOX INNER/MASTER
AU-GG1014	100 cc	217	32	45	182	59	36	15	454	1 / 36 pcs

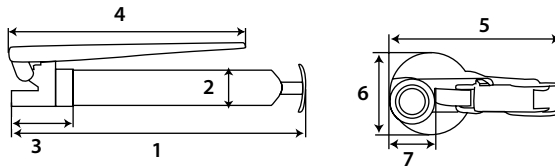

## SET HOSE HAND GREASE GUN 6 PCS

### SET 6 PCS SELANG POMPA GEMUK - TANGAN

- 1/2" Flexible hose 4500 psi
- 4 jaws coupler to fit strongly

ITEM CODE	SIZE	1 (mm)	2 (mm)	3 (mm)	4 (mm)	5 (mm)	6 (mm)	WEIGHT (gr)	QTY / BOX INNER/MASTER
AU-HG1369	6 PCS	330	31	9	7	13	40	549	6 pcs

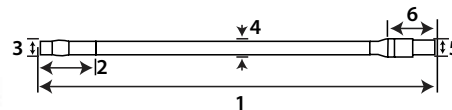

## HAND GREASE PUMP

### POMPA GEMUK - DRUM

- Wheel and handle for easy handling
- Energonomic pump handle
- Flexible hose and gun for easy use

ITEM CODE	SIZE	1 (mm)	2 (mm)	3 (mm)	4 (mm)	5 (mm)	6 (mm)	7 (mm)	8 (mm)	WEIGHT (gr)	QTY / BOX INNER/MASTER
AU-GP1012	20 L	780	295	440	150	430	16	455	1,470	10,000	1 pcs

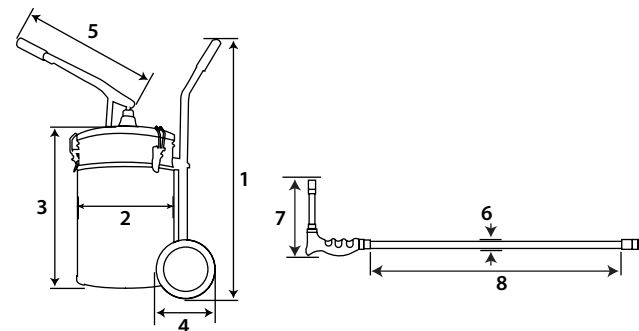



## HAND OIL PUMP

### POMPA OLI - DRUM

- Big volume storage tank
- Easy to re-fill the oil



ITEM CODE	SIZE	1 (mm)	2 (mm)	3 (mm)	4 (mm)	5 (mm)	6 (mm)	7 (mm)	WEIGHT (gr)	QTY / BOX INNER/MASTER
AU-OP1013	20 L	780	295	440	150	430	18	1,500	800	1 pcs

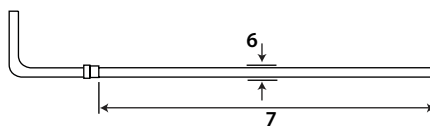
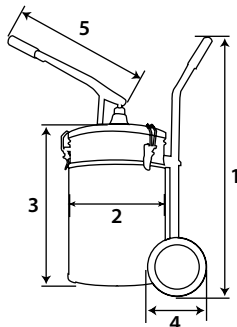

## OIL SUCTION GUN

### POMPA OLI - TANGAN

- Deluxe lip seal for maximum suction
- 12° Flexible delivery tube



ITEM CODE	SIZE	1 (mm)	2 (mm)	3 (mm)	4 (mm)	5 (mm)	6 (mm)	7 (mm)	WEIGHT (gr)	QTY / BOX INNER/MASTER
AU-SG1016	500 cc	289	60	55	245	318	34	14	148	1 / 20 pcs
AU-SG1291	1,000 cc	400	60	50	245	335	32	13	1,078	1 / 12 pcs

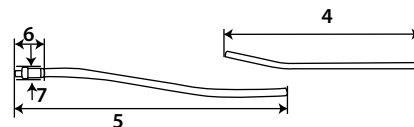
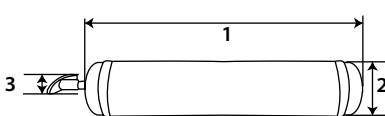

## RIM CROWBAR

### CONGKELAN BAN

- Material chrome vanadium
- Drop forged and properly heat-treated for super durability



ITEM CODE	SIZE	1 (mm)	2 (mm)	WEIGHT (gr)	QTY / BOX INNER/MASTER
AU-RC1017	10"	254	19	193	12 / 120 pcs
AU-RC1018	12"	300	22	195	12 / 96 pcs

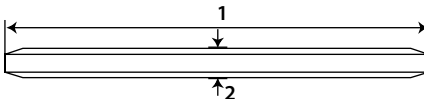



## PISTON RING COMPRESSOR

- Heavy spring steel compresses the stiffest rings evenly
- Positive lock action provides positive compression and fingertip release



ITEM CODE	SIZE	1 (mm)	2 (mm)	3 (mm)	4 (mm)	WEIGHT (gr)	QTY / BOX INNER/MASTER
AU-PC1446	3" X 57 - 125 mm	67	75	6	90	322	1 / 60 pcs
AU-PC1447	4" X 90 - 175 mm	69	110	6	90	294	1 / 60 pcs

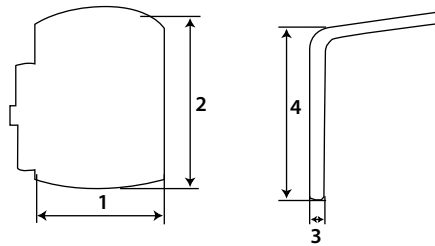

## MAGNETIC TRACKER TREKER MAGNET

- The product made by high quality material of CRMO SK5 within high torque strength for professional using
- Adjustable angle fixed jaws have convenience working easily
- Easy simple action to change the jaws be inside or outside working



ITEM CODE	SIZE	1 (mm)	2 (mm)	3 (mm)	4 (mm)	5 (mm)	6 (mm)	WEIGHT (gr)	QTY / BOX INNER/MASTER
AU-MT1020	GL	158	110	15	37	9	36	386	1 / 36 pcs
AU-MT1024	KN	121	111	16	37	9	36	415	1 / 36 pcs

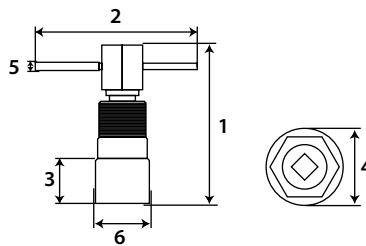

Keterangan  
GL = HONDA GL - PRO  
KN = KAWASAKI NINJA

## MAGNETIC TRACKER MULTI FUNCTION TREKER MAGNET MULTI FUNGSI

- Material Chrome Vanadium
- Design to magnetic uninstall
- Simple structure and easy to use
- High durable and corrosion resistance



ITEM CODE	SIZE	1 (mm)	2 (mm)	3 (mm)	4 (mm)	5 (mm)	6 (mm)	WEIGHT (gr)	QTY / BOX INNER/MASTER
AU-MT1030	NO 1	34	34	92	8	118	33	394	1 / 40 pcs
AU-MT1031	NO 2	34	34	92	8	118	33	388	1 / 40 pcs
AU-MT1032	NO 3	36	28	91	9	119	36	391	1 / 40 pcs
AU-MT1033	NO 4	31	50	102	9	119	31	450	1 / 40 pcs

Keterangan  
NO 1 = Honda (Kharisma, NSR, Tiger), Kawasaki (Ninja), Yamaha (RX), Suzuki (Satria, RC, Thunder 125)  
NO 2 = Honda (C7--, KC, GL, Grand, Tiger), Yamaha (RX-K, RX-S, RX-Z, Mio, Nouvo), Suzuki (GTO, RS, RGR, Satria F 150, Shogun)  
NO 3 = Yamaha (Alfa, Champ, Force 1)  
NO 4 = Honda (Neotech, Toger), Suzuki (RC), Yamaha (RX)



## MECHANIC CREEPER

- High quality plastic
- Smooth wheel
- Comfort base head and not sharp
- With the castors for good movability



ITEM CODE	SIZE	1 (mm)	2 (mm)	3 (mm)	4 (mm)	5 (mm)	6 (mm)	7 (mm)	WEIGHT (gr)	QTY / BOX INNER/MASTER
AU-MC1019	100 X 46 cm	1,000	470	200	85	450	25	47	4,900	1 pcs

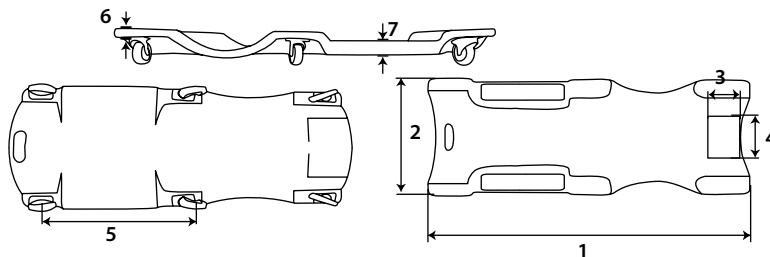

## DISC BRAKE SPREADER

**TREKER REM MOBIL**

- Suitable for use on all vehicle types and models
- Easily and quickly separates pistons in their calipers
- Simple on-hand installation



ITEM CODE	SIZE	1 (mm)	2 (mm)	3 (mm)	4 (mm)	5 (mm)	6 (mm)	WEIGHT (gr)	QTY / BOX INNER/MASTER
AU-DB1034	15.2 X 7.3 X 2.1 cm	153	114	9	5	6	12	750	1 / 24 pcs

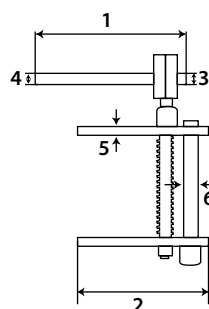

## BALL JOINT SEPARATOR

**TREKER BALL JOINT**

- Heat treated alloy steel
- Drop forged for extra strength
- High durable hardness



ITEM CODE	SIZE	1 (mm)	2 (mm)	3 (mm)	WEIGHT (gr)	QTY / BOX INNER/MASTER
AU-BJ1036	9"	159	92	31	1,270	1 / 20 pcs

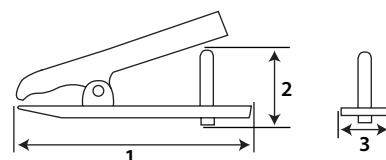

## FLANGE AXLE PULLER

**TREKER KAKI BEBEK**

- Material chrome vanadium



ITEM CODE	SIZE	1 (mm)	2 (mm)	3 (mm)	4 (mm)	WEIGHT (gr)	QTY / BOX INNER/MASTER
AU-AP1037	59 X 18 cm	576	380	15	82	4,118	1 / 24 pcs

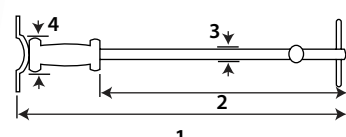



- Design for suitable use when arch is limited
- High safety when working in high-tension springs
- Jaw design is fitting to wrap coil claws for safely



## COIL SPRING COMPRESSOR (SINGLE)

TREKER PER MOBIL - SINGLE

ITEM CODE	SIZE	1 (mm)	2 (mm)	3 (mm)	WEIGHT (gr)	QTY / BOX INNER/MASTER
AU-CS1038	400 mm	450	32	20	2,160	1 box @ 10 set

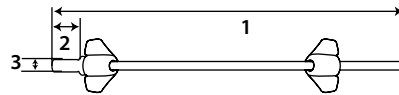

## COIL SPRING CLAMP (DOUBLE)

TREKER PER MOBIL - DOUBLE

- Design for suitable use when wheel arch is limited
- High safety when working on high-tension spring
- Jaw design is fitting to warp coil claws for safety



ITEM CODE	SIZE	1 (mm)	2 (mm)	3 (mm)	WEIGHT (gr)	QTY / BOX INNER/MASTER
AU-CS1039	400 mm	451	31	21	2254	1 box @ 10 set

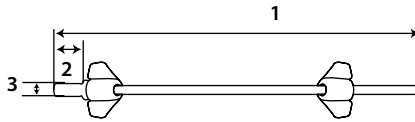

## UNIVERSAL HOLDER

TAHANAN KOPLING

- Material Chrome Vanadium



ITEM CODE	SIZE	1 (mm)	2 (mm)	3 (mm)	4 (mm)	WEIGHT (gr)	QTY / BOX INNER/MASTER
AU-UH1040	33 X 22 cm	330	123	64	19	481	3 box @ 12 pcs

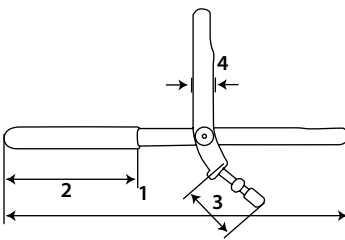

## CLUTCH SPRING CHECK TOOL

TAHANAN RUMAH KOPLING MOTOR MATIC

- Material Chrome Molybdenum



ITEM CODE	SIZE	1 (mm)	2 (mm)	3 (mm)	4 (mm)	5 (mm)	6 (mm)	WEIGHT (gr)	QTY / BOX INNER/MASTER
AU-CP1041	125 - 155 mm	135	20	109	167	83	35	1,470	24 pcs

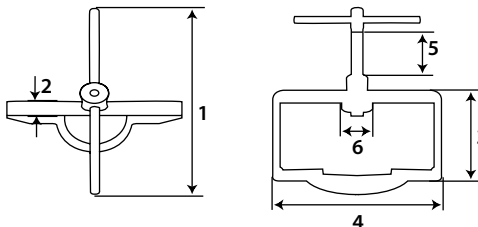



## PULLEY HOLDER 8 PCS (CRANKCASE/CRANKSHAFT)

TREKER RUMAH MESIN MOTOR

ITEM CODE	SIZE	1 (mm)	2 (mm)	3 (mm)	4 (mm)	5 (mm)	6 (mm)	7 (mm)	8 (mm)	9 (mm)	WEIGHT (gr)	QTY / BOX INNER/MASTER
AU-CR1042	8 pcs	148	~	200	~	~	94	65	57	48	1,500	12 pcs

• Material Chrome Molybdenum

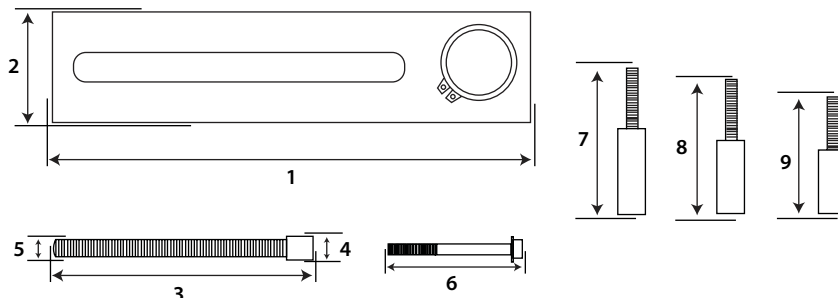

## HEAVY DUTY VALVE SPRING COMPRESSOR

TREKER KLEP MOBIL

- Material Chrome Molybdenum
- Specifically for small Engine applications
- Easily for replacing valve spring
- Suitable for different valve size

ITEM CODE	SIZE	1 (mm)	2 (mm)	3 (mm)	4 (mm)	5 (mm)	6 (mm)	WEIGHT (gr)	QTY / BOX INNER/MASTER
AU-SC1043	19 mm ~ 16.5 mm	47	244	108	25	130	50	1,235	1 box @ 12 set
	23 mm ~ 21.5 mm	47	244	108	25	130	50	1,235	1 box @ 12 set
	25 mm ~ 23.5 mm	47	244	108	25	130	50	1,235	1 box @ 12 set

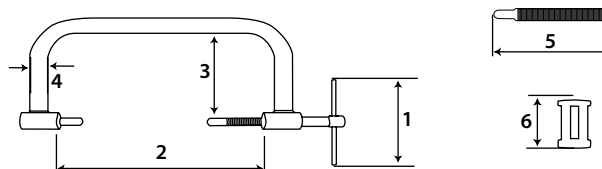

## BEARING PULLER

TREKER BEARING

- Easy to remove bearings
- Fully adjustable jaws
- Suitable for multiple bearings
- Molybdenum materials

ITEM CODE	SIZE	1 (mm)	2 (mm)	3 (mm)	4 (mm)	WEIGHT (gr)	QTY / BOX INNER/MASTER
AU-BP1044	AB 1	87	56	70	54	280	10 / 50 pcs
AU-BP1045	AB 2	107	83	131	78	677	10 / 30 pcs

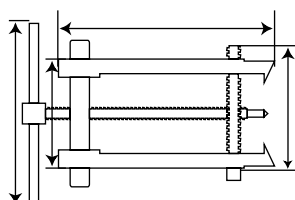





## BLIND BEARING PULLER

- Long slide chrome finish
- Chrome molybdenum extractor
- High durable hardness

ITEM CODE	SIZE	1 (mm)	2 (mm)	WEIGHT (gr)	QTY / BOX INNER/MASTER
AU-BB1851	-	390	12	~	1 / 10 pcs

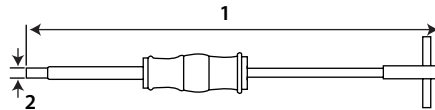

## TWO ARM PULLER

### TREKER KAKI 2

- Suitable for pulling hubs, flanges, gears, bearings as reduction type starter motor powertools, etc
- Made from High-Strength forged and hardened steel 3 jaws design

ITEM CODE	SIZE	1 (mm)	2 (mm)	3 (mm)	4 (mm)	WEIGHT (gr)	QTY / BOX INNER/MASTER
AU-AP1047	3"	100	75	10	6	227	1 / 60 pcs
AU-AP1048	4"	123	100	13	8	360	1 / 50 pcs
AU-AP1049	6"	171	150	17	10	810	1 / 30 pcs
AU-AP1050	8"	245	200	18	12	1,900	1 / 12 pcs
AU-AP1051	10"	325	250	25	18	3,700	1 / 6 pcs
AU-AP1052	12"	360	300	29	22	5,880	1 / 4 pcs

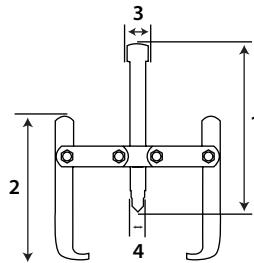

## THREE ARM PULLER

### TREKER KAKI 3

- Suitable for pulling hubs, flanges, gears, bearings as reduction type starter motor powertools, etc
- Made from High-Strength forged and hardened steel 3 jaws design

ITEM CODE	SIZE	1 (mm)	2 (mm)	3 (mm)	4 (mm)	WEIGHT (gr)	QTY / BOX INNER/MASTER
AU-AP1053	3"	100	75	11	7	320	1 / 60 pcs
AU-AP1054	4"	123	100	13	8	485	1 / 40 pcs
AU-AP1055	6"	171	150	17	10	1,100	1 / 20 pcs
AU-AP1056	8"	245	200	19	13	2,600	1 / 8 pcs
AU-AP1057	10"	320	250	25	18	4,980	1 / 4 pcs
AU-AP1058	12"	360	300	29	23	7,500	1 / 3 pcs

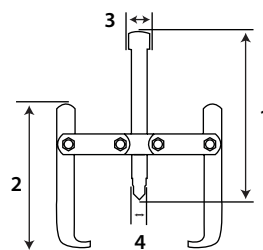



## ALL IN ONE GEAR PULLER

- Suitable for pulling hubs, flanges, gears, bearings and more
- Made from High-Strength forged and hardened steel 3 jaws design



ITEM CODE	SIZE	WEIGHT (gr)	QTY / BOX INNER/MASTER
AU-GP1035	220 X 133 X 17 X 17 X 12 mm	1,600	1 / 10 pcs

## CHAIN REMOVER

### PEMOTONG RANTAI

- Easy to disconnect roller chain
- Metal body for highly durable
- Suitable for motorcycle and bicycle chain



ITEM CODE	SIZE	1 (mm)	2 (mm)	3 (mm)	4 (mm)	WEIGHT (gr)	QTY / BOX INNER/MASTER
AU-CR1046	25 - 60	63	98	44	135	280	1 / 50 pcs

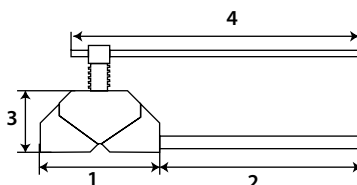

## BEARING SEPARATOR SET

- Blow mould case
- Easy to bring
- High durable hardness



ITEM CODE	CONTENT	WEIGHT (gr)	QTY / BOX INNER/MASTER
AU-SS1402	2 pcs Bearing Separator Capacity 30 x 50 mm (1 1/4" - 2 1/2") Capacity 50 x 75 mm (2 1/4" - 3 1/2")	4,690	1 / 5 set
	2 pcs 17 X L127 mm Extention Screw (Male & Female Threads)		
	2 pcs 17 X L127 mm Extention Screw (Male Threads)		
	2 pcs 17 X L103 mm Extention Screw (Male & Female Threads)		
	2 pcs 17 X L103 mm Extention Screw (Male Threads)		
	1 pcs 6" Bar - Type Puller Yoke		
	1 pcs Forcing Screw 9/16" X L175 mm		



# TEKIRO®



- Blow mould case
- Easy to bring
- High durable hardness



## FLANGE AXLE AND JAW PULLER SET

ITEM CODE	CONTENT	WEIGHT (gr)	QTY / BOX INNER/MASTER
AU-UA1403	3 pcs Internal / External Puller Jaws	7,697	1 / 2 set
	3 pcs Screws and Nuts		
	2 pcs Flange Axle Puller (Shallow & Deep)		
	1 pcs Heavy - Duty Slide Hammer		
	1 pcs Center Bolt And T - Bar		
	1 pcs 2 - Way Puller Cross Head		
	1 pcs 3 - Way Puller Cross Head		
	1 pcs Jaw Spreader Cone		
	1 pcs Puller Hook Adapter		
	1 pcs Locking Plier Adapter		
	1 pcs Dent Puller Screw Adapter		
	1 pcs Tapping Screw		
	1 pcs Forcing Screw 5/8" x L145 mm		

## OIL CAN



- Flexible hose
- Ergonomic design
- Strong metal can

ITEM CODE	SIZE	1 (mm)	2 (mm)	3 (mm)	4 (mm)	5 (mm)	WEIGHT (gr)	QTY / BOX INNER/MASTER
AU-OC1414	500 ml	55	87	154	38	~	184	1 / 80 pcs

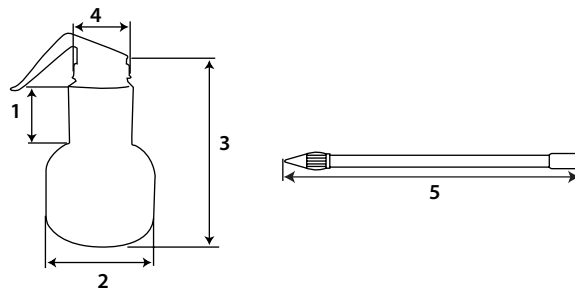

## GUN AIR LUBRICATOR

- Chrome vanadium plated finish
- Corrosion resistance
- Anti slip handle



ITEM CODE	SIZE	1 (mm)	2 (mm)	3 (mm)	4 (mm)	5 (mm)	6 (mm)	WEIGHT (gr)	QTY / BOX INNER/MASTER
AU-GL1587	284	24	48	170	9	14		949.0	1 / 20 pcs

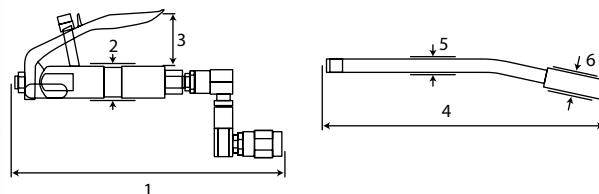

## SET DOOR UPHOLSTERY PANEL REMOVER

KUNCI PEMBUKA PANEL PINTU SET

- High durable hardness
- Width thickness
- Material chrome vanadium
- Nice grip on handle
- Ideal for the lining of doors, backdoors, quarter panels floor, etc



ITEM CODE	SIZE	1 (mm)	2 (mm)	3 (mm)	4 (mm)	5 (mm)	6 (mm)	7 (mm)	WEIGHT (gr)	QTY / BOX INNER/MASTER
AU-PP1506	240	120	34	28	5	6	13		116	1 / 48 pcs

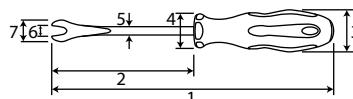

SCREWDRIVER

AUTOMOTIVE

STORAGE

TRAY



# TEKIRO®



SCREWDRIVER



AUTOMOTIVE



STORAGE



TRAY



## MECHANIC TOOLS 45 PCS AUTOMOTIVE TOOL SET (BESI)

ITEM CODE
45 PCS
AU-MT0978



SIZE	CONTENT	WEIGHT (gr)	QTY / BOX INNER/MASTER
45 pcs	9 pcs Socket 10 mm, 12 mm, 13 mm, 14 mm, 17 mm 19 mm, 21 mm, 22 mm, 24 mm	8,751	1 set
	1 pcs 1/2" DR. Spark Plug 21 mm		
	1 pcs 1/2" DR. Flexible Handle 15"		
	1 pcs 1/2" DR. Ratchet Handle 72 Teeth Rubber Handle 10"		
	1 pcs 1/2" DR. Extension Bar 5"		
	1 pcs Diagonal Plier 6"		
	1 pcs Long Nose Plier 6"		
	1 pcs Slip Joint Pliers 8"		
	1 pcs Water Pump Pliers 10"		
	1 pcs Ballpen Hammer 6 OZ		
	6 pcs Open End Wrench 6 X 7 mm, 10 X 11 mm, 12 X 13 mm 12 X 14 mm, 14 X 17 mm, 17 X 19 mm		
	6 pcs Boxes End Wrench 10 X 11 mm, 12 X 13 mm, 12 X 14 mm 14 X 17 mm, 19 X 21 mm, 22 X 24 mm		
	11 pcs Go-Thru Screwdriver (+) PH0 X 75 mm (3.2) (+) PH1 X 75 mm (5) (+) PH2 X 38 mm (6) (+) PH2 X 100 mm (6) (+) PH3 X 150 mm (8) (-) 3.2 X 75 mm, (-) 5 X 75 mm (-) 6 X 38 mm, (-) 6 X 100 mm (-) 8 X 150 mm, (-) 8 X 200 mm		
	1 pcs Adjustable Wrench 8"		
	1 pcs Adjustable Wrench 12"		
	1 pcs Kikir		
	1 pcs Metal Case		



# TEKIRO®



SCREWDRIVER



AUTOMOTIVE



STORAGE



TRAY



## COMBO FLUID EXTRUDER

- Evacuates all type of fluid
- Most Vehicle and machines
- Polyethylene construction for durable use



ITEM CODE	SIZE	1 (mm)	2 (mm)	3 (mm)	4 (mm)	5 (mm)	6 (mm)	WEIGHT (gr)	QTY / BOX INNER/MASTER
AU-CF1697	10 L	540	272	320	402	33	1,200	4,600	1 / 4 pcs

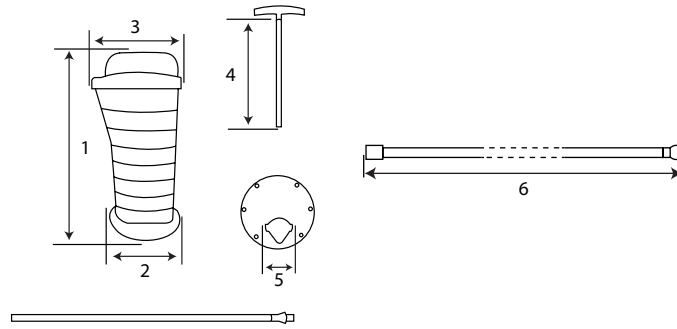

## VACUUM BRAKE FLUID BLEEDER

- High quality plastic
- Easy to use
- High durable



ITEM CODE	SIZE	1 (mm)	2 (mm)	3 (mm)	4 (mm)	5 (mm)	6 (mm)	WEIGHT (gr)	QTY / BOX INNER/MASTER
AU-VB1585	1 L	121	130	53	230	6	1,060	421.59	1 / 20 pcs

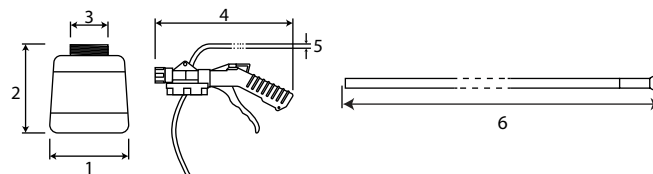

## UNIVERSAL VACUUM BRAKE FLUID BLEEDER SET

- High quality plastic
- Easy to use
- High durable
- Universal function



ITEM CODE	SIZE	1 (mm)	2 (mm)	3 (mm)	4 (mm)	5 (mm)	6 (mm)	7 (mm)	8 (mm)	WEIGHT (gr)	QTY / BOX INNER/MASTER
AU-VB1586	1 L	121	130	53	230	6	214	70	1,060	540.5	1 / 20 pcs

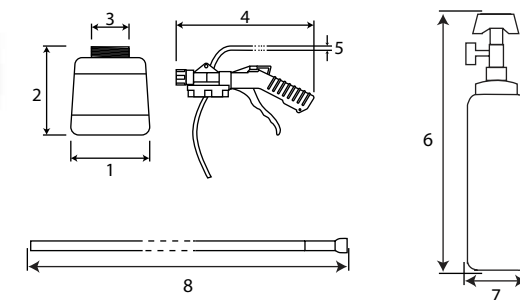



## MECHANIC TOOLS 50 PCS

HONDA TOOL KIT (BESI)

ITEM CODE	CONTENT	WEIGHT (gr)	QTY / BOX INNER/MASTER
AU-TS1427	4 pcs Combination Wrench 10 mm, 12 mm, 14 mm, 17 mm		1 set
	6 pcs Open End Wrench 6 X 7 mm, 8 X 9 mm, 10 X 12 mm 12 X 14 mm, 14 X 17 mm, 17 X 19 mm		
	5 pcs Box End Wrench 8 X 9 mm, 10 X 12 mm, 12 X 14 mm 14 X 17 mm, 17 X 19 mm		
	1 pcs Snap Ring 7" IS		
	1 pcs Snap Ring 7" ES		
	1 pcs Linesman Plier 8"		
	1 pcs Long Nose Plier 8"		
	1 pcs Diagonal Plier 8"		
	1 pcs Ball Pein Hammer With Fibre 16 OZ		
	1 pcs Double Plastic Hammer 35 mm		
	1 pcs Cooper Hammer 500 Gr		
	3 pcs T-Type Wrench With Screwdriver (+) PH2, (+) PH3, (-) 8		
	6 pcs T-Type Wrench 8 mm, 9 mm, 10 mm, 12 mm, 14 mm, 17 mm		
	2 pcs T-Type Spark Plug 10 mm, 12 mm		
	1 pcs Wheel Nut Wrench 10 mm		
	1 pcs Feeler Gauge 13 Blades		
	1 pcs Engine Block Wrench Flat 17 X 24 mm		
	1 pcs Valve Adjustable Wrench		
	3 pcs Feeler Gauge Roll 0.03 mm X 13 X 5, 0.05 mm X 13 X 5 0.1 mm X 13 X 5		
	4 pcs 1/2" DR. Impact Socket 6 PT 10 mm, 12 mm, 14 mm, 17 mm		
	4 pcs T-Type Wrench Extra Long 500 mm X 8 mm, 500 mm X 10 mm, 500 mm X 12 mm, 500 mm X 14 mm		
	1 pcs Tool Box 3 Tier size 52 x 20 x 29 mm		





## TIRE SEAL STRING

### OBAT TAMBAL BAN

- Butly Rubber Material
- Easy To Use
- Brown Colour String
- 2X stronger than other



ITEM CODE	SIZE	1 (mm)	WEIGHT (gr)	QTY / BOX INNER/MASTER
AU-TS1722	-	202	208	24 pcs

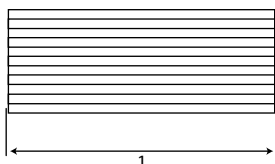

## TYRE KIT METAL

- Easy To Use
- Drop Forged For Extra Strength
- High Fully Polishing Finish
- Good design, comfortable steel handle durable



ITEM CODE	SIZE	1 (mm)	2 (mm)	3 (mm)	4 (mm)	5 (mm)	6 (mm)	WEIGHT (gr)	QTY / BOX INNER/MASTER
AU-TK1774		90	18	120	83	8	4	~	~

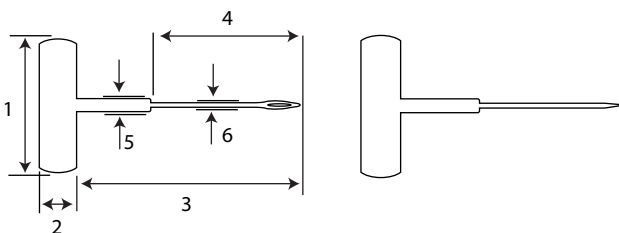

## TYRE KIT PLASTIC

- High quality plastic
- Easy To Use
- Drop Forged For Extra Strength
- High Polishing Finish
- Comfortable plastic handle



ITEM CODE	SIZE	1 (mm)	2 (mm)	3 (mm)	4 (mm)	5 (mm)	6 (mm)	WEIGHT (gr)	QTY / BOX INNER/MASTER
AU-TK1775		100	42	95	78	15	4	~	~

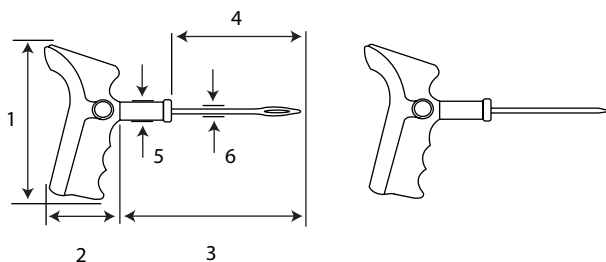



## MECHANIC TOOLS 59 PCS

### YAMAHA TOOL KIT (BESI)

ITEM CODE
59 PCS
AU-MT0979



SIZE	CONTENT	WEIGHT (gr)	QTY / BOX INNER/MASTER
59 pcs	5 pcs Open end wrench 6 X 7 mm, 8 X 10 mm, 12 X 14 mm 17 X 19 mm, 22 X 24 mm	9,376	1 set
	4 pcs Box End Wrench 8 X 10 mm, 12 X 14 mm 17 X 19 mm, 22 X 24 mm		
	10 pcs 3/8" DR. Socket 8 mm, 10 mm, 12 mm, 14 mm, 17 mm 19 mm, 21 mm, 22 mm, 23 mm, 24 mm		
	1 pcs 3/8" DR. Ratchet Handle 72 Teeth Rubber Handle 8"		
	1 pcs 3/8" DR. Sliding T Bar 8"		
	1 pcs 3/8" DR. Extension Bar 6"		
	2 pcs 3/8" DR. Spark Plug 16 mm, 21 mm		
	8 pcs Go-Thru Screw Driver (+) PH1 X 75 mm, (+) PH2 X 38 mm (+) PH2 X 100 mm (+) PH3 X 150 mm (-) 5 X 75 mm, (-) 6 X 38 mm (-) 6 X 100 mm, (-) 8 X 150 mm		
	1 pcs Slip Joint Plier 8"		
	1 pcs Long Nose Plier 6"		
	1 pcs Diagonal Plier 6"		
	1 pcs Snap Ring 7" IS		
	1 pcs Snap Ring 7" ES		
	1 pcs Adjustable Wrench 10"		
	1 pcs Ball Pein Hammer with Fibre 8 OZ		
	1 pcs Double Plastic Hammer 30 mm		
	8 pcs Hex Key Set 2-10 mm 2 mm, 2.5 mm, 3 mm, 4 mm 5 mm, 6 mm, 8 mm, 10 mm		
	1 set Impact Driver 11 pcs		
	1 pcs Plastic Handle Screwdriver (-) 3x 100 mm		
	1 pcs Feeler Gauge 13 Blades		
	1 pcs Scrapper		
	3 pcs T-Type Wrench Rubber Handle 8 mm, 10 mm, 12 mm		
	1 pcs Square Drive		
	1 pcs Metal Case		





## LABOR SAVING WRENCH 1:8

### KUNCI TORSI RODA TRUK

- Perfect tool for trucks, RVs or any other heavy duty vehicles
- Extended torque for hard to turn bolts.
- Comes in durable plastic case for easy travel.
- Material: High-quality Alloy steel



ITEM CODE	SIZE	WEIGHT (gr)	QTY / BOX INNER/MASTER
AU-LS1794	1:68	770	1 set

## TOOL BOX SET 66 PCS



ITEM CODE	CONTENT	WEIGHT (gr)	QTY / BOX INNER/MASTER
ST-TB1651	3 pcs TPR Go-Thru Screwdriver (-) 5 x 75 mm, 6x 100 mm, 8 x 200 mm		1 set
	2 pcs TPR Go-Thru Screwdriver (+) PH1 x 75 mm (5), PH2 x 100 mm (6)		
	14 pcs Combination Wrench (8 mm, 10 mm, 11 mm, 12 mm, 13 mm, 14 mm, 17 mm, 19 mm, 20 mm, 22 mm, 24 mm, 27 mm, 30 mm, 32 mm)		
	1 set Punch & Chisel Set 7 pcs		
	18 pcs Socket 1/2" DR 6 PT (10 mm, 11 mm, 12 mm, 13 mm, 14 mm, 15 mm, 16 mm, 17 mm, 18 mm, 19 mm, 20 mm, 21 mm, 22 mm, 23 mm, 24 mm, 27 mm, 30 mm, 32 mm)		
	1 pcs Ratchet Handle Kuning Hijau 1/2"		
	2 pcs Extention Bar 5",10"		
	1 pcs Universal Joint 1/2"		
	1 pcs Flexible Handle 1/2" x 15"		
	1 pcs Ball Pein Hammer 8 Oz		
	1 pcs Double Plastic Hammer 35 mm		
	1 pcs Kunci L Set 9 pcs (Panjang)		
	1 pcs Waterpump Pliers 10"		
	1 pcs Linesman Pliers 7"		
	1 pcs Long Nose Pliers 6"		
	1 pcs Diagonal Pliers 6"		
	1 pcs Tool Box 3 Susun (550x200x290 mm)		
	1 pcs EVA Tool Box Set		





## UNIVERSAL RADIATOR PRESSURE TEST KIT 18 PCS

- Special design of vacuum purge and refill tool connection fits nearly all types of radiator openings
- Convenient storage blow mold case and handle keeps this set together in your toolbox
- This universal radiator testers allows easy testing for leakage in radiator system and quick change of coolant, help you solve any problem about radiator pressure



ITEM CODE	CONTENT	WEIGHT (gr)	QTY / BOX INNER/MASTER
GT-TD1726	Dies M3 X 0.5	1,100	1 / 10 set
	Dies M4 X 0.7		
	Dies M5 X 0.8		
	Dies M6 X 1.0		
	Die Handle 1"OD		
	T-Type Wrench 1/4" Capacity		
	Screwpitch Gauge		
	Screwdriver		

## BATTERY TESTER

### ALAT TES AKI

- Automotive and household electrical problems safely and accurately
- Data hold and large digital display with backlit LCD for visibility in dimly light areas
- Note: This meter can not test AC current; ensure your Multimeter is set to the correct setting before testing

ITEM CODE	SIZE	WEIGHT (gr)	QTY / BOX INNER/MASTER
AU-BT1815	7 - 30 VDC		1 / 10 pcs

## HYDRAULIC PRESS 15 TON

### MESIN PRESS 15 TON

- Heavy Duty H-Frame Steel Construction with Extra Long Handle for Easy Pumping Force
- Base can moveable
- Shop press features an extremely ridged, fully welded main frame, allowing the operator to throw the full 15 tons at it with no worries.

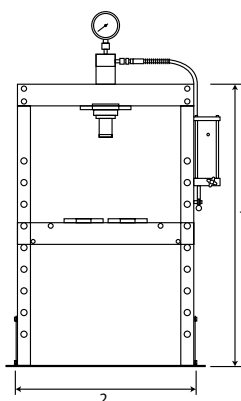

ITEM CODE	SIZE	1 (mm)	2 (mm)	WEIGHT (gr)	QTY / BOX INNER/MASTER
AU-HP1559	15 Ton	1,650	856	176,000	1 pcs



- High durable hardness
- Quick for press
- More accurate value

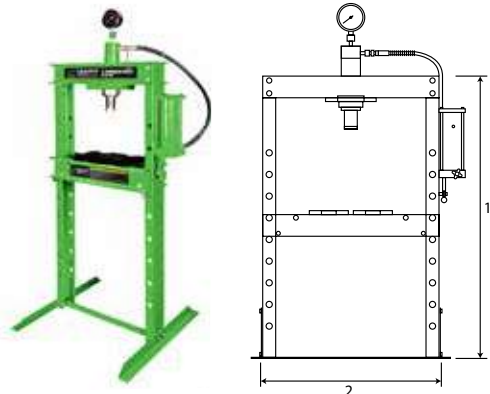

## HYDRAULIC PRESS 20 TON

### MESIN PRESS 20 TON

ITEM CODE	SIZE	1 (mm)	2 (mm)	WEIGHT (gr)	QTY / BOX INNER/MASTER
AU-HP1717	20 Ton	1,495	630	93,000	1 pcs

- Outrigger leg easily folded for transport or storage
- Universal wheel provide
- 4 position weight
- High lifting range



## ENGINE CRANE 2 TON

### ALAT PENGANGKAT MESIN 2 TON

ITEM CODE	SIZE	WEIGHT (gr)	QTY / BOX INNER/MASTER
AU-EC1588	2 Ton	85,600	1 pcs

- Made of high strength steel for maximum durability, and you can use it for a long time with stable performance.
- Comes with foot-operated pump and lowering pedal, great for high position installation and removal of automobile gearbox, car engines.
- Maximum load is 500 Kg



## TRANSMISSION JACK

### DONGKRAK MESIN

ITEM CODE	SIZE	WEIGHT (gr)	QTY / BOX INNER/MASTER
AU-TJ1812	500 KG	38,000	1 / 10 pcs



## AUTOMATIC NITROGEN GENERATOR

### MESIN PENGISIAN ANGIN NITROGEN

- Equipment adopts high-octane BF-200# Carbon Molecular sieve and core accessories are imported
- By presetting pressure the equipment can vacuum, fill N2 and test pressure automatically
- Pressure sensor of high precision made by US Novasensor
- Just One button can complete vacuum and nitrogen inflation



ITEM CODE	SIZE	PRESSURE OUTPUT	WEIGHT (kg)	QTY / BOX INNER/MASTER
AU-AN1813	70 L	6.8 Bar	128	1 pcs

## AUTOMATIC NITROGEN GENERATOR FOR MOTORCYCLE

### MESIN PENGISIAN ANGIN NITROGEN BAN SEPEDA MOTOR

- ~ Equipment adopts high-octane BF-200# Carbon Molecular sieve and core accessories are imported
- ~ by presetting pressure the equipment can fill N2 and test pressure automatically
- ~ Pressure sensor of high precision made by US Novasensor
- ~ Only for Motorcycle workshop



ITEM CODE	SIZE	PRESSURE OUTPUT	WEIGHT (kg)	QTY / BOX INNER/MASTER
AU-AN1814	40 L	6 Bar	87	1 pcs

## TIRE CHANGER

### MESIN PENGGANTI BAN

- Large cylinder for power arm
- Strong tire-pressing
- Smooth rotary pressing tire
- Shoveling tire smoothly

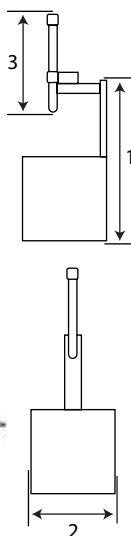

ITEM CODE	SPECIFICATION	QTY / BOX INNER/MASTER
AU-TC1679	Semi Automatic Swing Arm	1 pcs
	Special for Motorcycle Tire Changing	
	Motor Power: 0.75 KW	
	Max. Wheel Diameter: 41" ( 1.040 mm )	
	Max. Wheel Width: 14" ( 355 mm )	
	Clamping: 6" - 24"	
	Air Supply: 8 Bar	
Bread Breaker Force: 2.500 Kgs		