

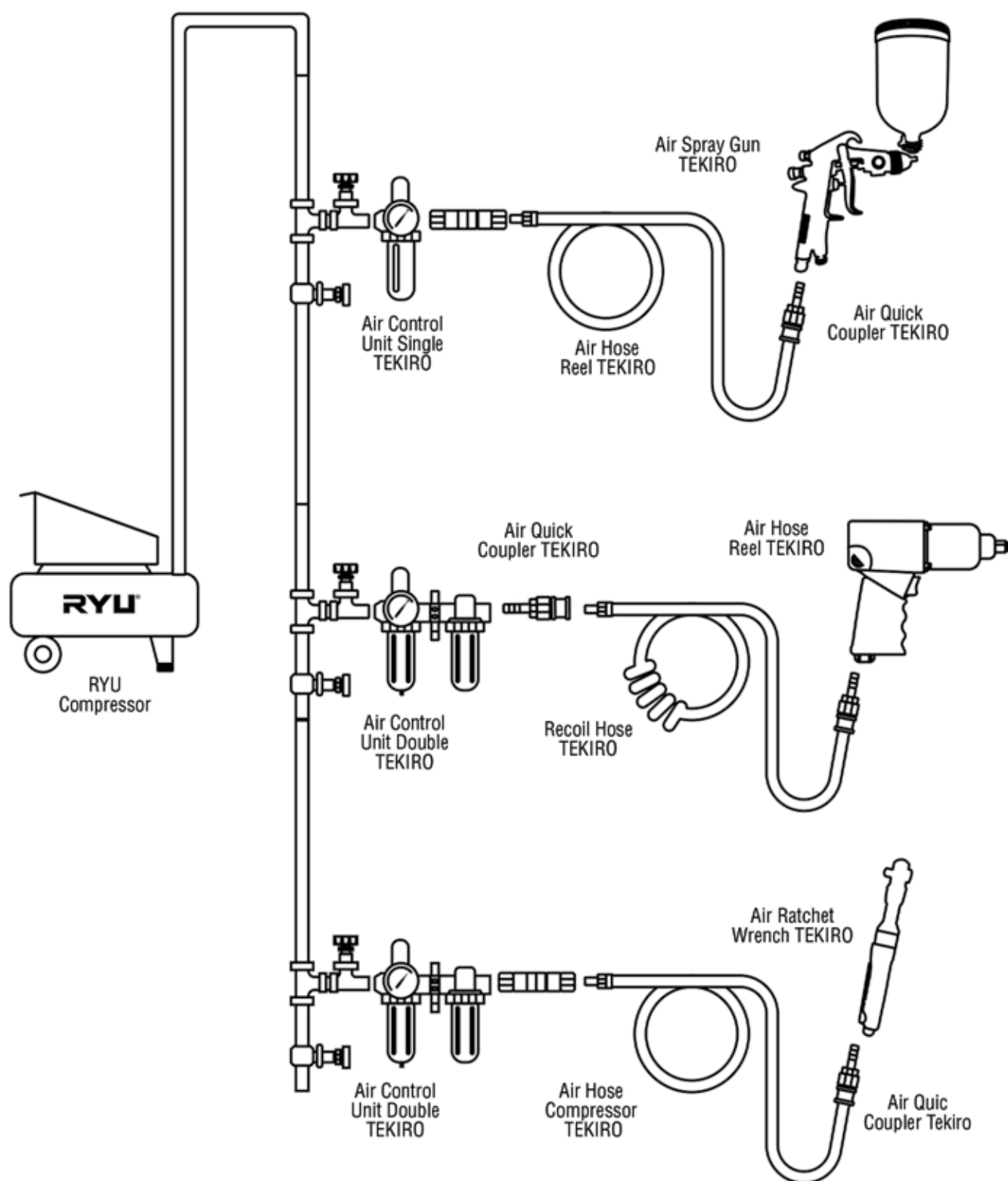



AIR TOOLS TEKIRO AIR LINE TOOLS DIAGRAM



AIR TOOLS

AIR QUICK COUPLER

TEKIRO air quick coupler is an industrial standard component for connecting air compressor systems used in automotive, agriculture, and industrial sectors. Made of (CrV) chrome vanadium material for durability, it exceeds the strictest requirement of Japanese Industrial Standard (JIS).

QUICK COUPLER ONE TOUCH

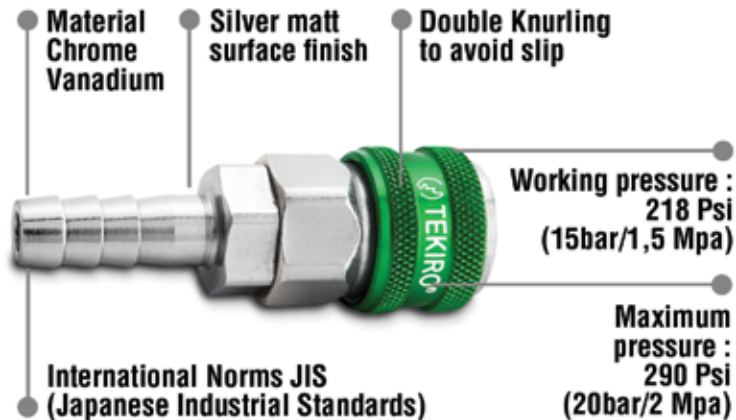

QUICK COUPLER TWO TOUCH

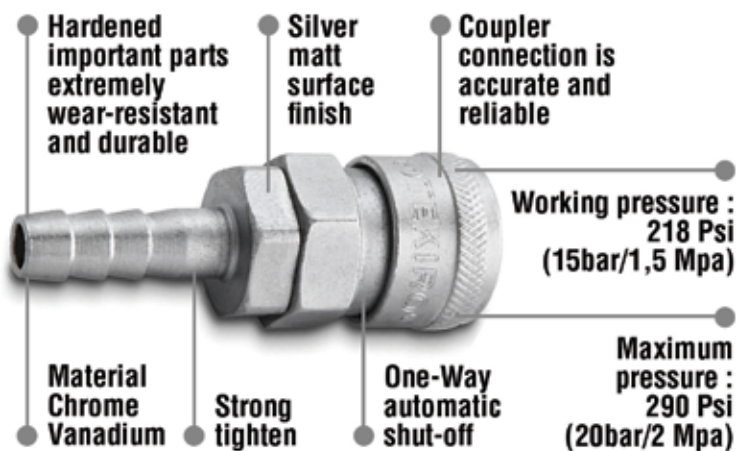

QUICK COUPLER PLUG

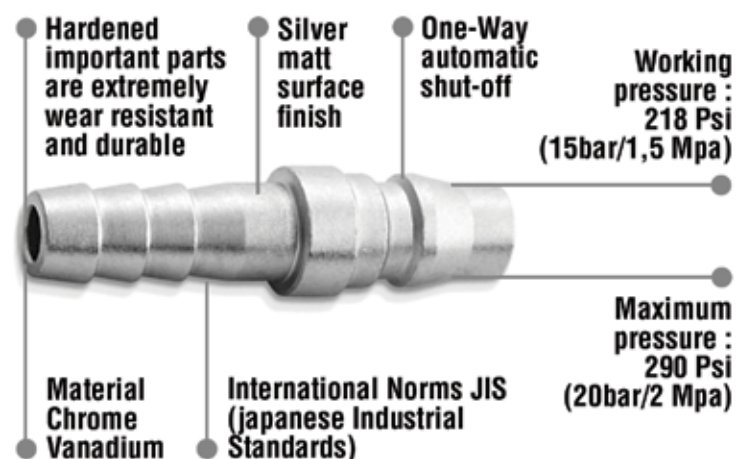

- Improved Operation
- Chrome Plated steel body for anti-corrosion
- One-touch series coupler could be widely applied for male and female thread connection, hose connectors and manifolds
- Meet the International Norms JIS (Japanese International Standard)

SPECIFICATION

Working Pressure	: 218psi (15bar/1,5Mpa)
Maximum Pressure	: 290psi (20bar/2Mpa)
Temperatur Range	: -20°C~ 80°C

AIR QUICK COUPLER ONE TOUCH SF

COUPLER ANGIN SATU LANGKAH SF

ITEM CODE	SIZE	1 (mm)	2 (mm)	3 (mm)	4 (mm)	WEIGHT (gr)	QTY / BOX INNER/MASTER
AT-QC1074	20 SF	53	17	18	25	86	5 / 150 pcs
AT-QC1075	30 SF	34	17	20	21	89	5 / 150 pcs
AT-QC1076	40 SF	55	17	25	21	99	5 / 150 pcs

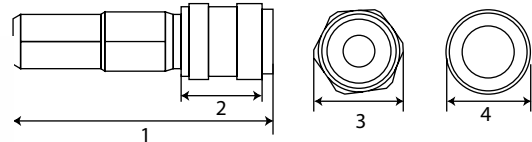

- Improved Operation
- Chrome Plated steel body for anti-corrosion
- One-touch series coupler could be widely applied for male and female thread connection, hose connectors and manifolds
- Meet the International Norms JIS (Japanese International Standard)

SPECIFICATION

Working Pressure	: 218psi (15bar/1,5Mpa)
Maximum Pressure	: 290psi (20bar/2Mpa)
Temperatur Range	: -20°C~ 80°C

AIR QUICK COUPLER ONE TOUCH SH

COUPLER ANGIN SATU LANGKAH SH

ITEM CODE	SIZE	1 (mm)	2 (mm)	3 (mm)	4 (mm)	WEIGHT (gr)	QTY / BOX INNER/MASTER
AT-QC1077	20 SH	69	17	9	21	79	5 / 150 pcs
AT-QC1078	30 SH	72	17	11	26	83	5 / 150 pcs
AT-QC1079	40 SH	76	17	12	21	91	5 / 150 pcs

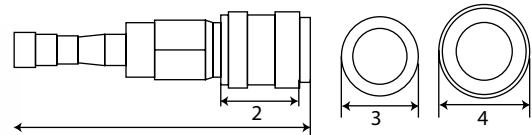

- Improved Operation
- Chrome Plated steel body for anti-corrosion
- One-touch series coupler could be widely applied for male and female thread connection, hose connectors and manifolds
- Meet the International Norms JIS (Japanese International Standard)

SPECIFICATION

Working Pressure	: 218psi (15bar/1,5Mpa)
Maximum Pressure	: 290psi (20bar/2Mpa)
Temperatur Range	: -20°C~ 80°C

AIR QUICK COUPLER ONE TOUCH SM

COUPLER ANGIN SATU LANGKAH SM

ITEM CODE	SIZE	1 (mm)	2 (mm)	3 (mm)	4 (mm)	WEIGHT (gr)	QTY / BOX INNER/MASTER
AT-QC1080	20 SM	56	17	12	21	79	5 / 150 pcs
AT-QC1081	30 SM	56	17	13	22	79	5 / 150 pcs
AT-QC1082	40 SM	57	17	21	25	92	5 / 150 pcs

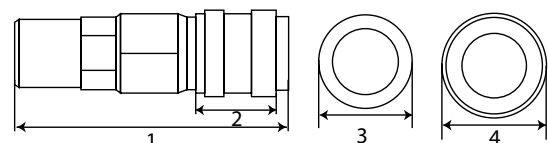

AIR QUICK COUPLER ONE TOUCH SP

COUPLER ANGIN SATU LANGKAH SP

ITEM CODE	SIZE	1 (mm)	2 (mm)	3 (mm)	4 (mm)	WEIGHT (gr)	QTY / BOX INNER/MASTER
AT-QC1083	20 SP	56	17	13	26	82	5 / 150 pcs
AT-QC1084	30 SP	56	17	25	21	102	5 / 150 pcs
AT-QC1085	40 SP	57	17	13	21	81	5 / 150 pcs

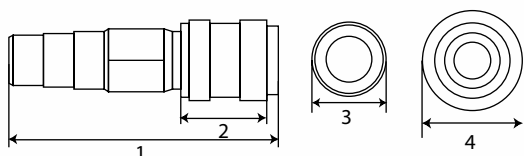

- Improved Operation
- Chrome Plated steel body for anti-corrosion
- One-touch series coupler could be widely applied for male and female thread connection, hose connectors and manifolds
- Meet the International Norms JIS (Japanese International Standard)

SPECIFICATION

Working Pressure	: 218psi (15bar/1.5Mpa)
Maximum Pressure	: 290psi (20bar/2Mpa)
Temperatur Range	: -20°C~ 80°C

AIR QUICK COUPLER TWO TOUCH SF

COUPLER ANGIN DUA LANGKAH SF

ITEM CODE	SIZE	1 (mm)	2 (mm)	3 (mm)	WEIGHT (gr)	QTY / BOX INNER/MASTER
AT-QC1086	20 SF	46	19	23	75	10 / 200 pcs
AT-QC1087	30 SF	47	20	23	79	10 / 200 pcs
AT-QC1088	40 SF	48	25	23	91	10 / 200 pcs

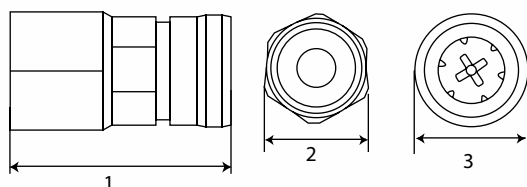

- Improved Operation
- Chrome Plated steel body for anti-corrosion
- Two-touch series coupler could be widely applied for male and female thread connection, hose connectors and manifolds
- Meet the International Norms JIS (Japanese International Standard)

SPECIFICATION

Working Pressure	: 218psi (15bar/1.5Mpa)
Maximum Pressure	: 290psi (20bar/2Mpa)
Temperatur Range	: -20°C~ 80°C

AIR QUICK COUPLER TWO TOUCH SH

COUPLER ANGIN DUA LANGKAH SH

ITEM CODE	SIZE	1 (mm)	2 (mm)	3 (mm)	WEIGHT (gr)	QTY / BOX INNER/MASTER
AT-QC1089	20 SH	62	9	23	67	10 / 200 pcs
AT-QC1090	30 SH	63	11	23	69	10 / 200 pcs
AT-QC1091	40 SH	67	12	23	90	10 / 200 pcs

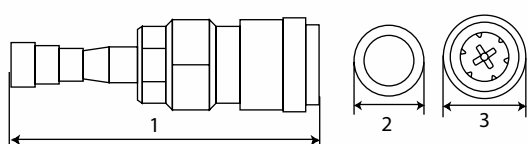

- Improved Operation
- Chrome Plated steel body for anti-corrosion
- Two-touch series coupler could be widely applied for male and female thread connection, hose connectors and manifolds
- Meet the International Norms JIS (Japanese International Standard)

SPECIFICATION

Working Pressure	: 218psi (15bar/1.5Mpa)
Maximum Pressure	: 290psi (20bar/2Mpa)
Temperatur Range	: -20°C~ 80°C

- Improved Operation
- Chrome Plated steel body for anti-corrosion
- Two-touch series coupler could be widely applied for male and female thread connection, hose connectors and manifolds
- Meet the International Norms JIS (Japanese International Standard)

SPECIFICATION

Working Pressure	: 218psi (15bar/1.5Mpa)
Maximum Pressure	: 290psi (20bar/2Mpa)
Temperatur Range	: -20°C~ 80°C

AIR QUICK COUPLER TWO TOUCH SM

COUPLER ANGIN DUA LANGKAH SM

ITEM CODE	SIZE	1 (mm)	2 (mm)	3 (mm)	WEIGHT (gr)	QTY / BOX INNER/MASTER
AT-QC1092	20 SM	48	13	23	67	10 / 200 pcs
AT-QC1093	30 SM	49	16	23	71	10 / 200 pcs
AT-QC1094	40 SM	50	20	23	82	10 / 200 pcs

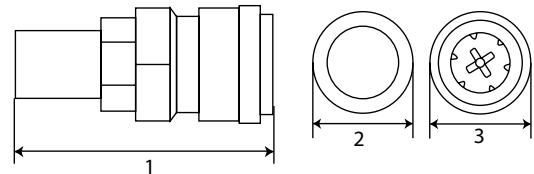

- Improved Operation
- Chrome Plated steel body for anti-corrosion
- Two-touch series coupler could be widely applied for male and female thread connection, hose connectors and manifolds
- Meet the International Norms JIS (Japanese International Standard)

SPECIFICATION

Working Pressure	: 218psi (15bar/1.5Mpa)
Maximum Pressure	: 290psi (20bar/2Mpa)
Temperatur Range	: -20°C~ 80°C

AIR QUICK COUPLER TWO TOUCH SP

COUPLER ANGIN DUA LANGKAH SP

ITEM CODE	SIZE	1 (mm)	2 (mm)	3 (mm)	WEIGHT (gr)	QTY / BOX INNER/MASTER
AT-QC1095	20 SP	48	12	23	68	10 / 200 pcs
AT-QC1096	30 SP	50	14	23	74	10 / 200 pcs
AT-QC1097	40 SP	54	17	23	82	10 / 200 pcs

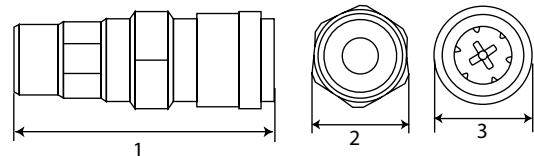

- One-Way automatic shut-off in the socket
- Wide Variety provides choice accordingly to application
- Hardened important parts are extremely wear resistant and durable
- Tested 100.000 Times, coupler connection is accurate and reliable
- Meet the International Norms JIS (Japanese International Standard)

SPECIFICATION

Working Pressure	: 218psi (15bar/1.5Mpa)
Maximum Pressure	: 290psi (20bar/2Mpa)
Temperatur Range	: -20°C~ 80°C

AIR QUICK COUPLER PLUG PF

COUPLER ANGIN PLUG PF

ITEM CODE	SIZE	1 (mm)	2 (mm)	3 (mm)	WEIGHT (gr)	QTY / BOX INNER/MASTER
AT-QC1098	20 PF	37	10	17	29	20 / 400 pcs
AT-QC1099	30 PF	39	10	20	38	20 / 400 pcs
AT-QC1100	40 PF	40	10	24	51	20 / 400 pcs

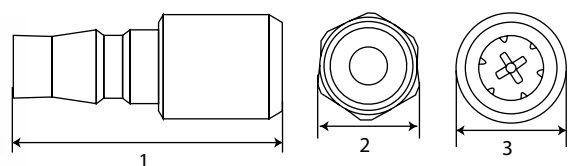

AIR QUICK COUPLER PLUG PH

COUPLER ANGIN PLUG PH

ITEM CODE	SIZE	1 (mm)	2 (mm)	3 (mm)	WEIGHT (gr)	QTY / BOX INNER/MASTER
AT-QC1101	20 PH	53	10	10	24	20 / 400 pcs
AT-QC1102	30 PH	55	10	10	30	20 / 400 pcs
AT-QC1103	40 PH	55	10	10	30	20 / 400 pcs

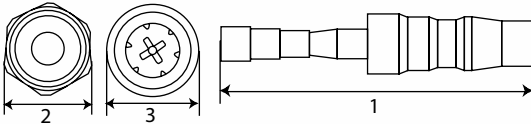

- One-Way automatic shut-off in the socket
- Wide Variety provides choice accordingly to application
- Hardened important parts are extremely wear resistant and durable
- Tested 100.000 Times, coupler connection is accurate and reliable
- Meet the International Norms JIS (Japanese International Standard)

SPECIFICATION

Working Pressure	: 218psi (15bar/1.5Mpa)
Maximum Pressure	: 290psi (20bar/2Mpa)
Temperatur Range	: -20°C~ 80°C

AIR QUICK COUPLER PLUG PM

COUPLER ANGIN PLUG PM

ITEM CODE	SIZE	1 (mm)	2 (mm)	3 (mm)	WEIGHT (gr)	QTY / BOX INNER/MASTER
AT-QC1104	20 PM	41	13	11	25	20 / 400 pcs
AT-QC1105	30 PM	42	10	16	37	20 / 400 pcs
AT-QC1106	40 PM	42	10	19	42	20 / 400 pcs

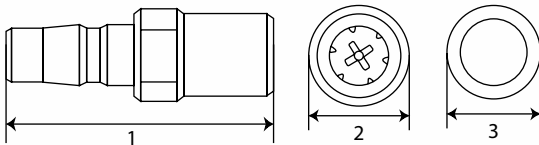

- One-Way automatic shut-off in the socket
- Wide Variety provides choice accordingly to application
- Hardened important parts are extremely wear resistant and durable
- Tested 100.000 Times, coupler connection is accurate and reliable
- Meet the International Norms JIS (Japanese International Standard)

SPECIFICATION

Working Pressure	: 218psi (15bar/1.5Mpa)
Maximum Pressure	: 290psi (20bar/2Mpa)
Temperatur Range	: -20°C~ 80°C

AIR QUICK COUPLER PLUG PP

COUPLER ANGIN PLUG PP

ITEM CODE	SIZE	1 (mm)	2 (mm)	3 (mm)	WEIGHT (gr)	QTY / BOX INNER/MASTER
AT-QC1107	20 PP	40	10	13	25	20 / 400 pcs
AT-QC1108	30 PP	42	10	14	32	20 / 400 pcs
AT-QC1109	40 PP	45	10	17	50	20 / 400 pcs

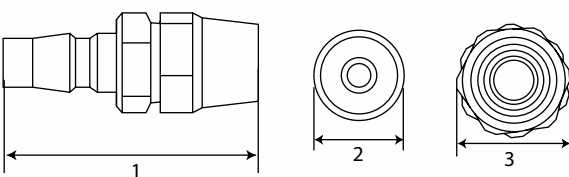

- One-Way automatic shut-off in the socket
- Wide Variety provides choice accordingly to application
- Hardened important parts are extremely wear resistant and durable
- Tested 100.000 Times, coupler connection is accurate and reliable
- Meet the International Norms JIS (Japanese International Standard)

SPECIFICATION

Working Pressure	: 218psi (15bar/1.5Mpa)
Maximum Pressure	: 290psi (20bar/2Mpa)
Temperatur Range	: -20°C~ 80°C

- Wide Variety provides choice accordingly to application
- Hardened important parts are extremely wear resistant and durable
- Tested 100.000 Times, coupler connection is accurate and reliable
- Meet the International Norms JIS (Japanese International Standard)

AIR QUICK COUPLER 2 WAY

COUPLER ANGIN CABANG 2

ITEM CODE	SIZE	1 (mm)	2 (mm)	3 (mm)	4 (mm)	5 (mm)	WEIGHT (gr)	QTY / BOX INNER/MASTER
AT-QC1674	2 Way	35	35	35	13	14	226	1 / 27 pcs

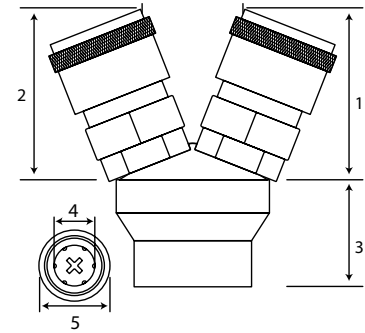

SPECIFICATION

Working Pressure	: 218psi (15bar/1.5Mpa)
Maximum Pressure	: 290psi (20bar/2Mpa)
Temperatur Range	: -20°C~ 80°C

- Wide Variety provides choice accordingly to application
- Hardened important parts are extremely wear resistant and durable
- Tested 100.000 Times, coupler connection is accurate and reliable
- Meet the International Norms JIS (Japanese International Standard)

AIR QUICK COUPLER 3 WAY

COUPLER ANGIN CABANG 3

ITEM CODE	SIZE	1 (mm)	2 (mm)	3 (mm)	4 (mm)	5 (mm)	WEIGHT (gr)	QTY / BOX INNER/MASTER
AT-QC1675	3 Way	35	35	35	13	23	256	1 / 27 pcs

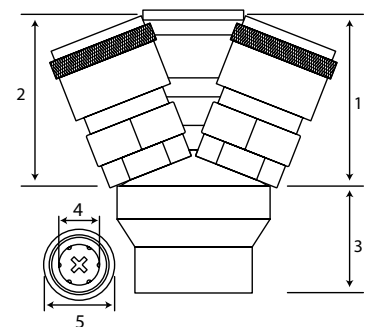

SPECIFICATION

Working Pressure	: 218psi (15bar/1.5Mpa)
Maximum Pressure	: 290psi (20bar/2Mpa)
Temperatur Range	: -20°C~ 80°C

AIR QUICK COUPLER 4 WAY

COUPLER ANGIN CABANG 4

ITEM CODE	SIZE	1 (mm)	2 (mm)	3 (mm)	4 (mm)	5 (mm)	WEIGHT (gr)	QTY / BOX INNER/MASTER
AT-QC1676	4 Way	30	30	122	13	23	369	1 / 35 pcs

- Wide Variety provides choice accordingly to application
- Hardened important parts are extremely wear resistant and durable
- Tested 100.000 Times, coupler connection is accurate and reliable
- Meet the International Norms JIS (Japanese International Standard)

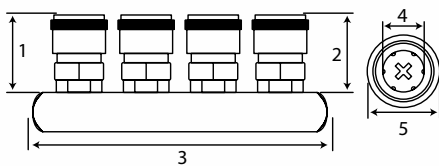

SPECIFICATION

Working Pressure	: 218psi (15bar/1.5Mpa)
Maximum Pressure	: 290psi (20bar/2Mpa)
Temperatur Range	: -20°C~ 80°C

ENGINE CLEANING GUN

ALAT SEMPROTAN ANGIN PEBERSIH MESIN

ITEM CODE	SIZE	1 (mm)	2 (mm)	3 (mm)	4 (mm)	5 (mm)	6 (mm)	WEIGHT (gr)	QTY / BOX INNER/MASTER
AT-CG1110	15"	245	12	35	144	6	1,200	296	1 / 50 pcs

- Material Chrome Vanadium
- All purpose spray cleaning ability
- Extended wand gets into hard to reach places
- Adjustable solvent flow
- Working Pressure 90~120 psi

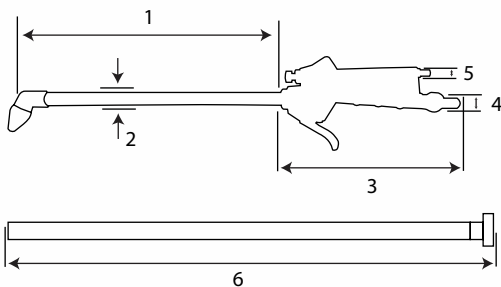



AIR TOOLS AIR DUSTER GUN

TEKIRO Air Duster gun is made of high quality alloy material, sturdy, safe, corrosion resistant and durable to use. Corrosion resistant materials make the compressed air perfect for cleaning automotive components, eliminating water, dust and dirt.

- Powerful airflow, low consumption and every saving
- Thin and long nozzle able to generate fast and narrow air flow that could reach into deep holes and narrow slits that is difficult to clean



Wide range of applications

widely use for blowing dust, water, powder, debris and various industrial or household cleanup and blow-off operations.



Working Site Blow Off

ideal for carpentry workplace and industrial workshop dust or powders blow off.



Working Site Blow Off

Thin and Long nozzle, ideal for carpentry workplace and industrial workshop dust or powders blow off.

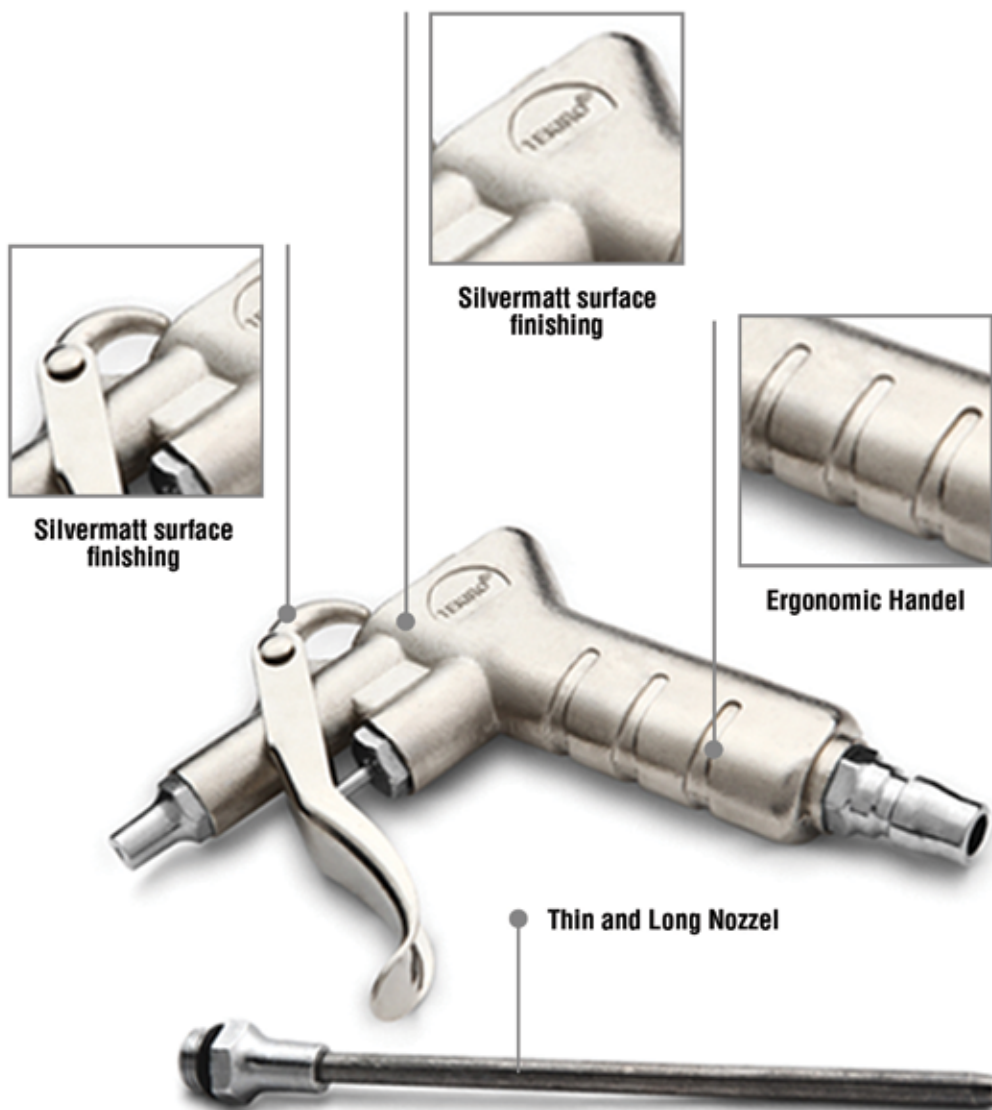

AIR DUSTER GUN

SEMPROTAN ANGIN 2 FUNGSI

ITEM CODE	SIZE	1 (mm)	2 (mm)	3 (mm)	4 (mm)	5 (mm)	AIR INLET (inch)	WEIGHT (gr)	QTY / BOX INNER/MASTER
AT-AD1111	DG1-3	120	5	26	123	8	1/4	190	10 / 100 pcs

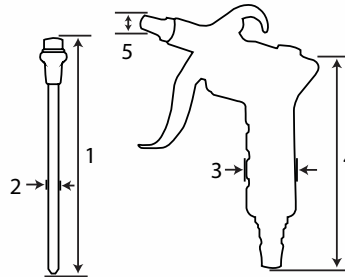

- The air blow gun uses high quality alloy material, sturdy, safe, antirust and durable to use
- Powerful air flow, low consumption and energy-saving
- Thin and long nozzle able to generate fast and narrow air flow that could reach into deep holes and narrow slits that is difficult to clean



AIR WASHING GUN

ALAT SEMPROTAN ANGIN PEMBERSIH MESIN TABUNG

ITEM CODE	SIZE	1 (mm)	2 (mm)	3 (mm)	4 (mm)	AIR INLET (inch)	WEIGHT (gr)	QTY / BOX INNER/MASTER
AT-WG1112	500 cc	211	106	360	12	1/4	438	1 / 10 pcs

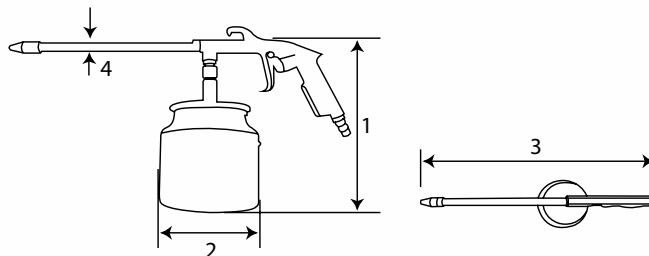

- Alloy structure body. Fits for 1/4" diameter
- Powerful blowing, low consumption and energy-saving
- Thin and long nozzle able to generate fast and narrow air flow that could reach into deep holes and narrow slits that is difficult to clean
- Rated pressure: 90psi
- Max. pressure: 150psi



AIR BLOW GUN

SEMPROTAN ANGIN

ITEM CODE	SIZE	1 (mm)	2 (mm)	3 (mm)	4 (mm)	5 (mm)	6 (mm)	WEIGHT (gr)	QTY / BOX INNER/MASTER
AT-BG1627	5"	231	137	98	40	13	10	194	20 / 100 pcs
AT-BG1628	12"	391	266	132	40	12	11	267	15 / 75 pcs

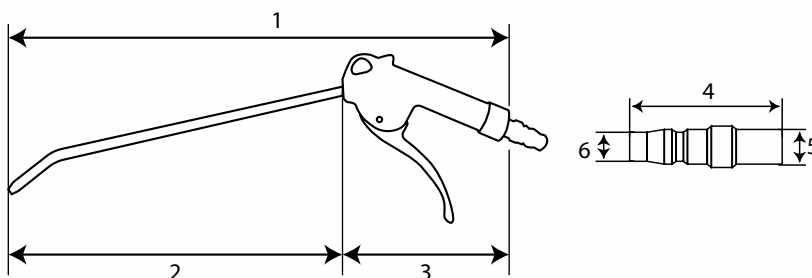

- Full pressure nozzle
- Super-gripping handle
- Ideal for quick cleaning
- Working Pressure 170psi



AIR TOOLS COMPRESSED AIR HOSE

TEKIRO compressed air hoses are specifically manufactured to transfer high pressure gases. It comes in a range of sizes and length with different temperatures and pressures. Understanding the maximum values within an intended application of an air hose is critical in ensuring safety for the user and longevity in the hose. The flexibility of Tekiro compressed air hoses allow the user to work freely in or around most circumstances or can fix the hoses in place around a workstation without the need for angle or corner connectors.

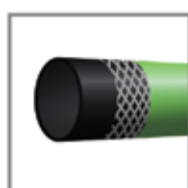

Rubber and copper material



Outer material with abrasion resistant



RECOIL HOSE GREEN

The **TEKIRO** recoil hose with spring is perfect for installations requiring flexibility in confined spaces and all-weather flexibility. Good resistance to shock and abrasion, together with a design integrating straight ends, allow for the easy and safe operation of pneumatic equipment.



Installed Quick Coupler, Plug and Bend Restrictors

Installed 1/4" quick coupler and plug for directly to connect air compressor and air tools. The bend restrictors to reduce kinking and to increase the life of the hose.



Self-Coiling

Self-recoils after extension during use for save your spacing



Flexible all weather

Excellent polyurethane material offers flexibility in all weather even at -40 to +150 degree F

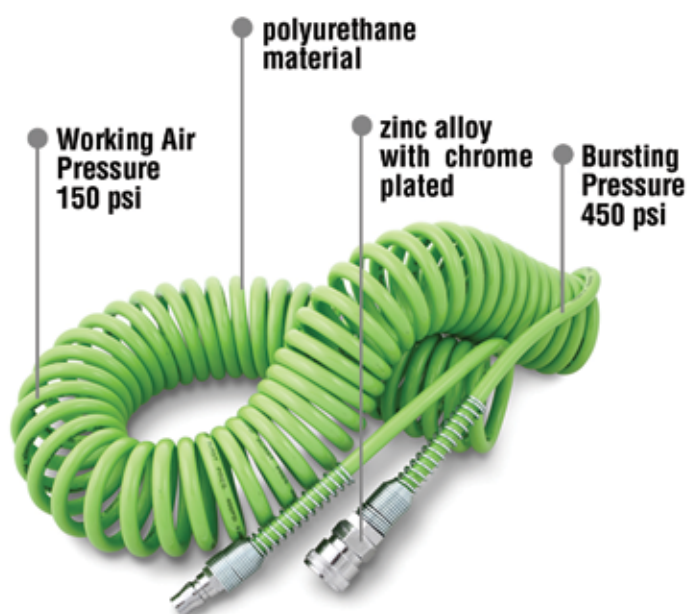

RECOIL HOSE WITH SPRING (GREEN COLOUR)

SELANG ANGIN SPIRAL HIJAU

ITEM CODE	SIZE	1 (mm)	2 (mm)	WORKING PRESSURE (Psi)	BURST PRESSURE (Psi)	WEIGHT (gr)	QTY / BOX INNER/MASTER
AT-RH1115	6 m (5 X 8 mm)	300	50	150	450	350	48 pcs
AT-RH1116	9 m (5 X 8 mm)	450	50	150	450	461	36 pcs
AT-RH1117	12 m (5 X 8 mm)	600	50	150	450	590	36 pcs
AT-RH1118	15 m (5 X 8 mm)	750	50	150	450	694	30 pcs
AT-RH1123	6 m (8 X 12 mm)	300	80	135	400	656	40 pcs
AT-RH1124	9 m (8 X 12 mm)	500	80	135	400	887	25 pcs
AT-RH1125	12 m (8 X 12 mm)	660	80	135	400	1,130	20 pcs

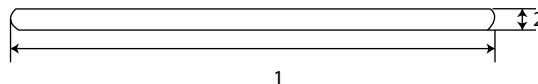

- Hose I.D : 5 mm, O.D : 8 mm
- Hose material : polyurethane
- Coupler : zinc alloy with chrome plated
- Working temperature : -20°C ~ 60°C



RECOIL HOSE WITH SPRING (YELLOW COLOUR)

SELANG ANGIN SPIRAL KUNING

ITEM CODE	SIZE	1 (mm)	2 (mm)	WORKING PRESSURE (Psi)	BURST PRESSURE (Psi)	WEIGHT (gr)	QTY / BOX INNER/MASTER
AT-RH1119	6 m (5 x 6 mm)	300	50	150	450	348	48 pcs
AT-RH1120	9 m (5 x 6 mm)	450	56	150	450	454	36 pcs
AT-RH1121	12 m	600	51	150	450	592	36 pcs
AT-RH1122	15 m	750	57	150	450	667	30 pcs

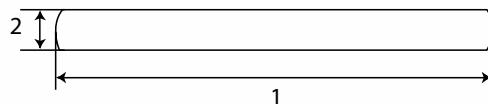

- Hose I.D : 5 mm, O.D : 6 mm
- Hose material : polyurethane
- Coupler : zinc alloy with chrome plated
- Working temperature : -20°C ~ 60°C



AIR HOSE REEL

SELANG ANGIN GULUNGAN

ITEM CODE	SIZE	1 (mm)	2 (mm)	3 (mm)	4 (mm)	WEIGHT (gr)	QTY / BOX INNER/MASTER
AT-AH1625	6 M	280	133	26	12	20,000	1 / 5 pcs

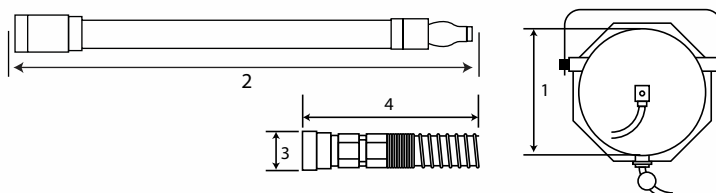

- High quality impact resistant
- PU Hose material
- Strong handle swivel bracket



- Outer material with abrasion resistant
- Flexible and easy to handle
- Can supply liquid fertilizer
- Coupling (flexible, 13.8 thread)

COMPRESSED AIR HOSE

SELANG TEKANAN TINGGI

ITEM CODE	SIZE	1 (mm)	WORKING PRESSURE (bar)	BURST PRESSURE (bar)	WEIGHT (gr)	QTY / BOX INNER/MASTER
AT-AH1622	8.5 X 14 mm (10 M)	13	60	200	1,520	1 / 6 pcs
AT-AH1621	8.5 X 14 mm (100 M)	14	60	200	15,200	1 / 1 pcs
AT-AH1776	8.5 X 15 mm (20 M)	15	60	200	2,883	1 / 6 pcs
AT-AH1777	8.5 X 15 mm (50 M)	15	60	200	8,000	1 / 1 pcs



- 20 L Large Tank Capacity
- Suitable for grease #1 - #3
- Steel material tank
- Easy greasing at high pressure

AIR LUBRICATOR FOR GREASE

POMPA GEMUK TENAGA ANGIN

ITEM CODE	SIZE	1 (mm)	2 (mm)	3 (mm)	4 (mm)	5 (mm)	6 (mm)	WEIGHT (gr)	QTY / BOX INNER/MASTER
AT-AL1128	20 L	117	121	430	350	310	1,200	17 kg	1 set

SPECIFICATION

Max. output capacity	: 30 c.c./sec
Max. output pressure	: 180 - 405 kg/cm ²
Shank length pump	: 430 mm
Max-min air pressure	: 4 - 9 kg/cm ²

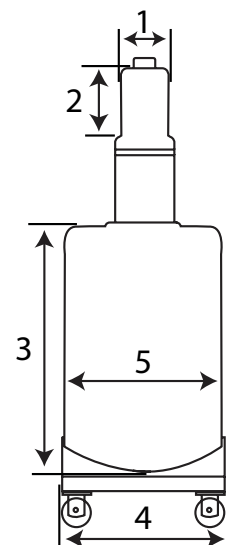
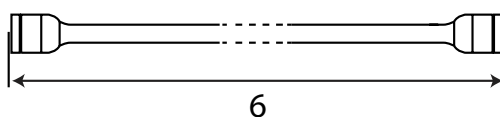



AUTOMOTIVE

STORAGE

TRAY

AIR TOOLS

HEX KEY

GENERAL TOOLS



AIR SCREWDRIVER

TEKIRO Air Screwdriver is ideal for high furniture and car production lines. This provides durability, power and speed for assembly and manufacturing applications with affordable opportunities. This increases productivity and improves product quality through precision torque control and user comfort. Ergonomic design allows users to work for long periods without fatigue.

- Ergonomic design of the industrial air screwdriver highly reduce fatigues while deliver the best performance.
- Equipped with screw head quick connector: 1/4" (6.35mm) ensures that bit won't drop accidentally, easy to operate.
- Forward reverse switch controls the bit to move clockwise or anticlockwise, so people can install or remove the screw conveniently



FORWARD REVERSE SWITCH

Forward reverse switch controls the bit to move clockwise or anticlockwise, so people can install or remove the screw conveniently.



PRESS SWITCH

Press switch allows people to start and stop the screwdriver easily.



SELF LOCKING HEAD

The 1/4" self locking head ensures that bit won't drop accidentally.

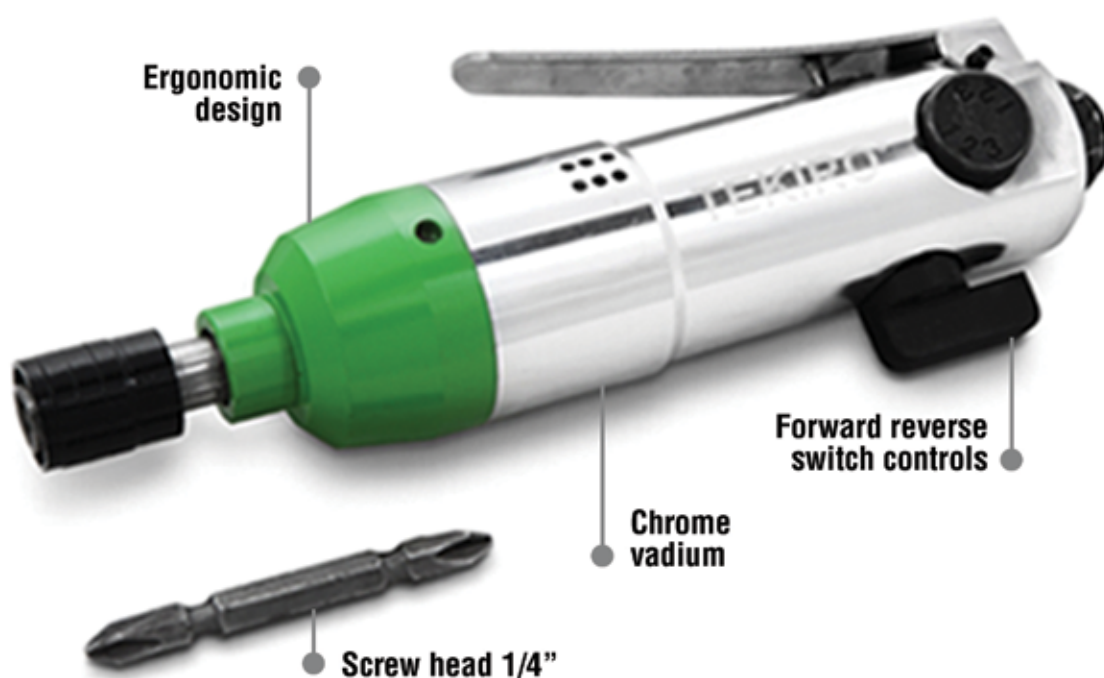

HEAVY DUTY AIR DIE GRINDER

1/4" DR. GERINDA TENAGA ANGIN

ITEM CODE	SIZE	1 (mm)	2 (mm)	3 (mm)	4 (mm)	5 (mm)	6 (mm)	WEIGHT (gr)	QTY / BOX INNER/MASTER
AT-AG1629	1/4"	169	28	37	119	32	24	543.0	1 / 25 pcs

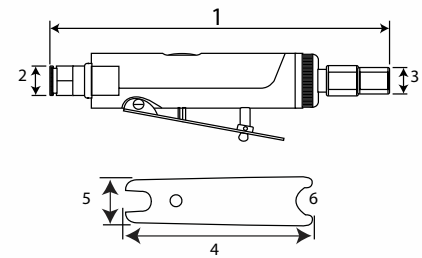

SPECIFICATION

Collet Size	: 1/4"
Length	: 6"
Free Speed	: 25,000rpm
Weight	: 3/4 lbs
Overall Length	: 5-1/4"
Average Air Consumption	: 4CFM
Recommended Hose Size	: 3/8" I.D.
Air Inlet	: 1/4" NPT
Maximum Air Pressure	: 90psi

AIR IMPACT SCREWDRIVER

1/4" DR. ALAT PEMBUKA SKRUP TENAGA ANGIN

ITEM CODE	SIZE	1 (mm)	2 (mm)	3 (mm)	4 (mm)	5 (mm)	6 (mm)	WEIGHT (gr)	QTY / BOX INNER/MASTER
AT-AS1302	1/4"	188	93	17	42	64.5	6	672	1 / 20 pcs



- Ergonomic design of the industrial air screwdriver highly reduce fatigues while deliver the best performance
- Equipped with screw head quick connector: 1/4" (6.35mm) ensures that bit won't drop accidentally, easy to operate
- Forward reverse switch controls the bit to move clockwise or anticlockwise, so people can install or remove the screw conveniently

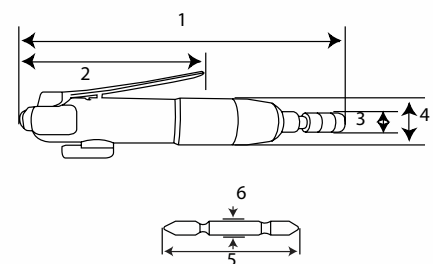

SPECIFICATION

Capacity	: 5/32"-33/16"
Free Speed	: 8000rpm
Max Torque	: 20-60in.lbs / 23-69kgs-cm
Air Inlet	: 1/4"
Air hose(ID)	: 3/8"
Average Air Consumption	: 6CFM
Working Pressure	: 90Psi/6.3bar
Hex Shank Size	: 1/4"

- Rubber grip handle more comfortable
- Simply to add stapler bullets

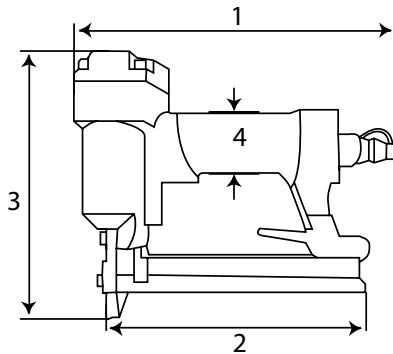

SPECIFICATION

Capacity	: 100 staples
Staple Size	: 20 gauge(1.20*0.60mm)
Staple Crown Size	: 0.44"(11.2mm)
Staple Lengths	: 13/32"to 7/8"(10 to 22mm)
Operating Pressure	: 60-110psi(4-7.5bar)
Max Pressure	: 120psi(8.3bar)
Air Consumption	: 0.9 SCFM@90psi
Air Inlet	: 1/4" NPT or BSP

AIR STAPLER

ALAT TEMBAK STAPLES TENAGA ANGIN

ITEM CODE	SIZE	1 (mm)	2 (mm)	3 (mm)	4 (mm)	WEIGHT (gr)	QTY / BOX INNER/MASTER
AT-AS1130	11.2x10-22mm	234	191	172	42	1,117	1 / 10 pcs

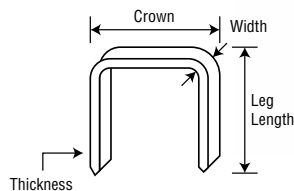

- Rubber grip handle more comfortable
- Simply to add nail bullets

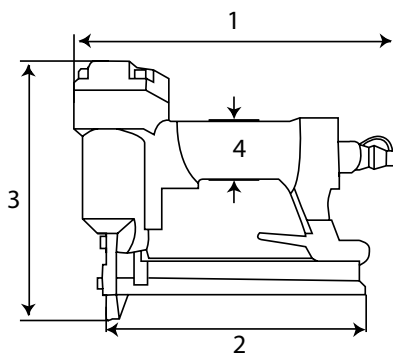

SPECIFICATION

Capacity	: 100 nails
Nails Size	: 18 gauge(1.05*1.25mm)
Nails Lengths	: 3/8"to 1-3/16"(10 to 30mm)
Operating Pressure	: 60-110 Psi(4-7.5bar)
Max Pressure	: 120psi(8.3bar)
Air Consumption	: 0.9 SCFM@90 psi
Air Inlet	: 1/4" NPT or BSP

AIR NAILER F30 C

ALAT TEMBAK PAKU TENAGA ANGIN F30C

ITEM CODE	SIZE	1 (mm)	2 (mm)	3 (mm)	4 (mm)	WEIGHT (gr)	QTY / BOX INNER/MASTER
AT-AN1129	1.05 X 1.25 mm	233	206	183	42	1,030	1 / 10 pcs

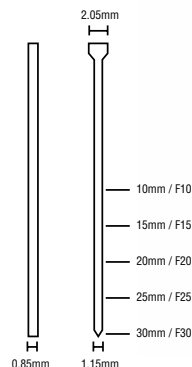

AIR RIVETER-1

ALAT TEMBAK RIVET TENAGA ANGIN

ITEM CODE	SIZE	1 (mm)	2 (mm)	3 (mm)	4 (mm)	WEIGHT (gr)	QTY / BOX INNER/MASTER
AT-AR1806	3/16"	262	165	78	119	1,600	1 / 10 pcs

SPECIFICATION

Traction Power	: 2680lbs (1219Kg)
Tool Stroke	: 0.552" (14mm)
Nose Pieces	: 2.4-3.2-4.0-4.8mm
AVG-AIR Consumption	: 3.5 CFM
Rivet Material	: Aluminum & Stainless
Work Capacity	: up to 5/32" (4mm) In All Material up to 3/16" (4.8mm) In AL. & Steel Blinds
Working Pressure	: 60 ~ 100psi
Air Inlet	: 1/4" PT (NPT)

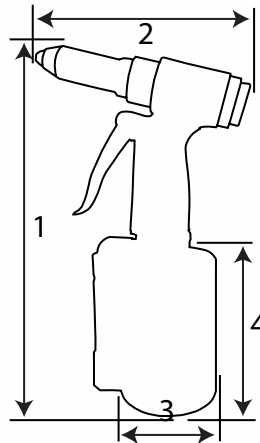

- Compact, lightweight cast aluminum body, ergonomic design for easy operation
- Powerful : 2.680 lbs of traction power to efficiently handle tough jobs

MICRO AIR DIE GRINDER KIT

MICRO GERINDA TENAGA ANGIN SET 16 PCS

ITEM CODE	CONTENT	WEIGHT (gr)	QTY / BOX INNER/MASTER
AT-AG1132	1 pcs Micro Die Grinder	690	1 / 20 set
	1 pcs Mini Oiler		
	1 pcs Oil Pot		
	2 pcs Hand Wrenches		
	1 pcs Female Nipple		
	10 pcs Mounted Stones		

- General industrial application air micro grinder, especially for industrial moulding
- Versatile kit for all types of applications
- 1/4" collets design with 60.000 Rpm





AIR SPRAY GUN

TEKIRO air gun adopted H.V.L.P technology

The high volume and low-pressure atomization technology is adapted to have a fine atomizing effect, thus achieving an optimal combination of quality and efficiency: 10%-30% paint can be saved as compared with a common spray gun)



H.V.L.P Air Cap Set



Precision Trigger



Aluminum 400 ml



Optimal Pressure :
4 Bar / 57 Psi



Ergonomic Handle

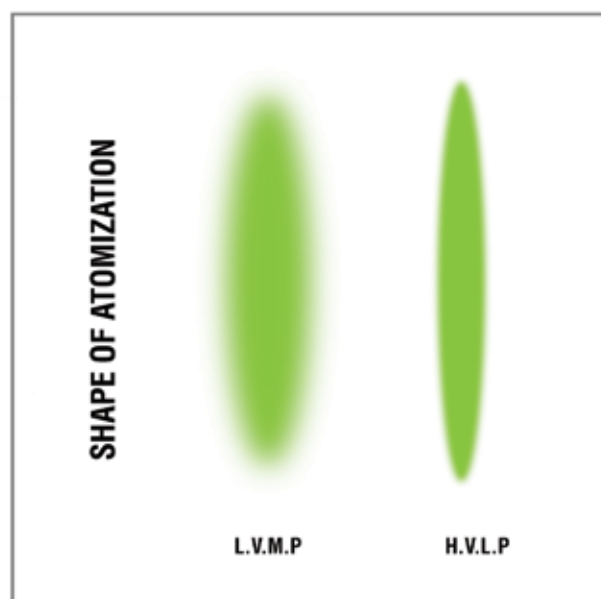
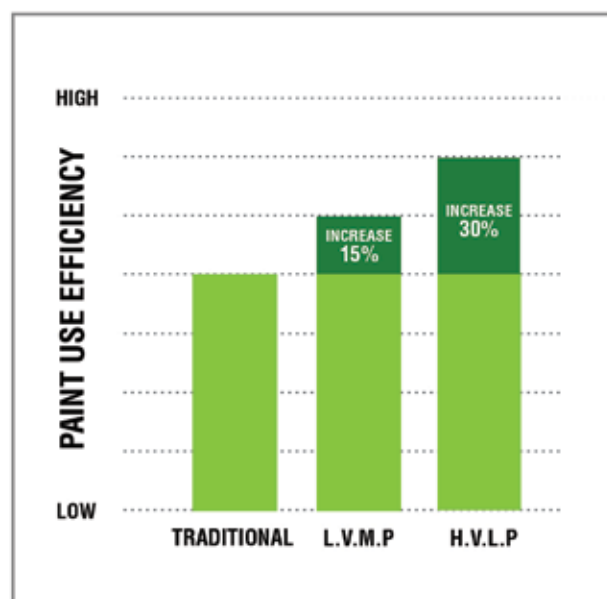

AIR SPRAY GUN

SEMPROTAN CAT TABUNG ATAS

ITEM CODE	SIZE	1 (mm)	2 (mm)	3 (mm)	4 (mm)	WEIGHT (gr)	QTY / BOX INNER/MASTER
AT-AS1616	F75 G	149	29	27	150	750	1 / 20 pcs
AT-AS1618	F100 G	87	90	130	172	847	1 / 20 pcs

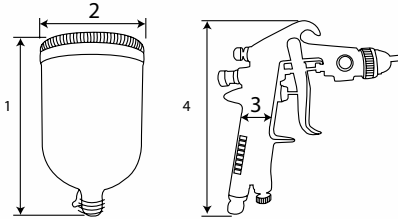

SPECIFICATION

	AT-AS1616	AT-AS1618
Optimal Working Pressure	4.0 bar / 57psi	4.0bar / 57psi
Pattern Width	About 200mm	About 240mm
Air Consumption	2-3cfm	2.5-3.5cfm
Capacity of Cup	Aluminum 400ml	Aluminum 400ml
Air Inlet	1/4" (bsp/npt/nps)	1/4" (bsp/npt/nps)
Nozzle Size	1.5 mm	1.5 mm



- Made by special steel
- Removable nozzle
- Perfect pulverization
- Stable spraying shape

AIR SPRAY GUN

SEMPROTAN CAT TABUNG BAWAH

ITEM CODE	SIZE	1 (mm)	2 (mm)	3 (mm)	4 (mm)	5 (mm)	WEIGHT (gr)	QTY / BOX INNER/MASTER
AT-AS1617	F75 S	120	119	874	15	173	750	1 / 20 pcs
AT-AS1619	F100 S	87	90	84	15	172	847	1 / 20 pcs

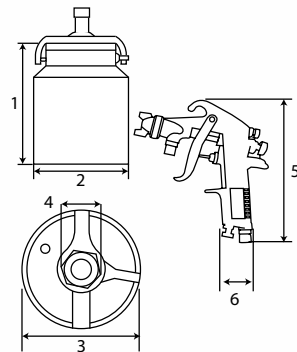

SPECIFICATION

	AT-AS1617	AT-AS1619
Optimal Working Pressure	4.0bar / 57psi	4.0 bar/ 5 psi
Pattern Width	About 200mm	About 240mm
Air Consumption	2-3cfm	2.5-3.5cfm
Capacity of Cup	Aluminum 750ml	Aluminum 600ml
Air Inlet	1/4" (bsp/npt/nps)	1/4" (bsp/npt/nps)
Nozzle Size	1.5 mm	1.5 mm



- Made by special steel
- Removable nozzle
- Perfect pulverization
- Stable spraying shape

AIR SPRAY GUN K-3

SEMPROTAN CAT TABUNG ATAS K-3

ITEM CODE	SIZE	1 (mm)	2 (mm)	3 (mm)	4 (mm)	WEIGHT (gr)	QTY / BOX INNER/MASTER
AT-AS1620	K-3	55	105	145	28	378	1 / 30 pcs

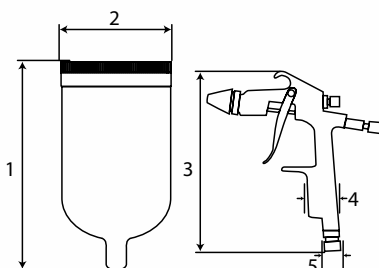

SPECIFICATION

	AT-AS1620
Optimal Working Pressure	2.5bar / 36psi
Pattern Width	About 50mm
Air Consumption	1-2cfm
Capacity of Cup	Aluminum 200ml
Air Inlet	1/4" (bsp/npt/nps)
Nozzle Size	0.5 mm



- Made by special steel
- Removable nozzle
- Perfect pulverization
- Stable spraying shape

- Made by special steel
- Removable nozzle
- Perfect pulverization
- Stable spraying shape



AIR SPRAY GUN 472B

SEMPROTAN CAT TABUNG BAWAH 472B

ITEM CODE	SIZE	1 (mm)	2 (mm)	3 (mm)	4 (mm)	5 (mm)	WEIGHT (gr)	QTY / BOX INNER/MASTER
AT-AS1720	472 B	135	100	65	100	60	700	1 / 10 pcs

SPECIFICATION

	AT-AS1720
Optimal Working Pressure	4.0bar / 57psi
Pattern Width	About 250mm
Air Consumption	3.5-6.0cfm
Capacity of Cup	Aluminum 750ml
Air Inlet	1/4" (bsp/npt/nps)
Nozzle Size	1.5 mm

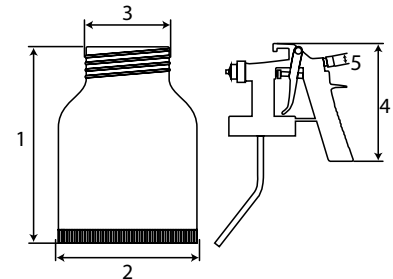

- Made by special steel
- Perfect pulverization
- Stable spraying shape



AIR SPRAY GUN K3A

SEMPROTAN CAT TABUNG ATAS K3A

ITEM CODE	SIZE	1 (mm)	2 (mm)	3 (mm)	4 (mm)	5 (mm)	WEIGHT (gr)	QTY / BOX INNER/MASTER
AT-AS1868	K3A	150	28	13	115	55	300	1 / 30 pcs

SPECIFICATION

	AT-AS1868
Optimal Working Pressure	2.0bar / 29psi
Pattern Width	About 140mm
Air Consumption	2-3cfm
Capacity of Cup	Aluminum 125ml
Air Inlet	1/4" (bsp/npt/nps)
Nozzle Size	0.5 mm

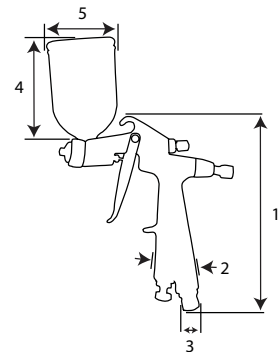

- Made by special steel
- Removable nozzle
- Perfect pulverization
- Stable spraying shape
- Include regulator



AIR SPRAY GUN K350 KIT

SEMPROTAN CAT TABUNG ATAS K350 KIT

ITEM CODE	SIZE	1 (mm)	2 (mm)	3 (mm)	4 (mm)	5 (mm)	6 (mm)	WEIGHT (gr)	QTY / BOX INNER/MASTER
AT-AS1869	K350 KIT	168	29	13	88	53	41	500	1 / 20 pcs

SPECIFICATION

	AT-AS1869
Optimal Working Pressure	2.0bar / 29psi
Pattern Width	About 100mm
Air Consumption	5-5.5cfm
Capacity of Cup	Aluminum 125ml
Air Inlet	1/4" (bsp/npt/nps)
Nozzle Size	0.5 mm

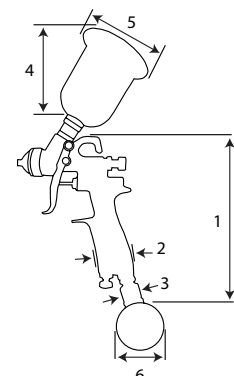



AIR CONTROL UNIT

TEKIRO CONTROL UNIT have Full control over operating air pressure is provided by locking the airflow adjustment knob. Water Moisture Trap Filter: Removes solid particles and condensation associated with compressed air. Provides you clean, dry air which prevents damage to air tools and pneumatic equipment. Has an easy release drain valve. Micro-Fog Lubricator: Supplies lubricating oil to pneumatic equipment in the proper proportions of oil to air consumption

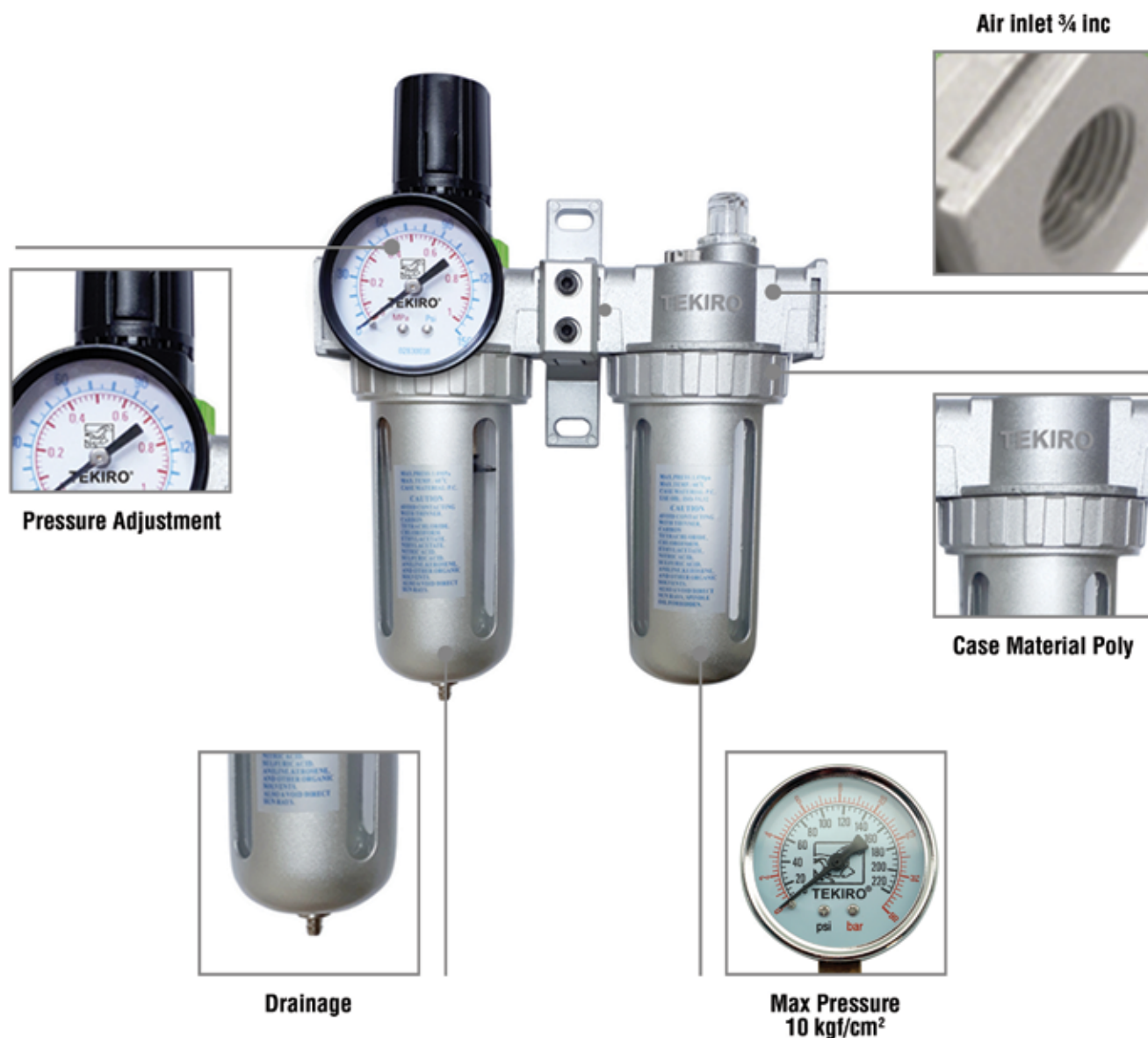

SAFETY INSTRUCTION

- Please clean the port and fitting before installation, it will effectively avoid bring dust to the air path.
- Pay attention to the direction of airflow and an arrow pointing on product body if correct, minding port and thread size if match.
- Pull up the knob of pressure gauge, rotate:
 - Clockwise rotation, the pressure will rise steadily.
 - Counterclockwise, the pressure will down
 - Stop turning after reaching the required index and lock down the knob, forget this step you may face leakage problem
- Rotate the needle valve in the "+" direction to increase the oil absorption speed, and it will slow down or stop when you rotate to "-" direction.

AIR CONTROL UNIT SINGLE

SARINGAN UDARA 1 TABUNG



ITEM CODE	SIZE	1 (mm)	2 (mm)	3 (mm)	4 (mm)	5 (mm)	AIR INLET (inch)	WEIGHT (gr)	QTY / BOX INNER/MASTER
AT-AC1702	3/4"	214	47	30	40	50	3/4	634	1 / 20 pcs

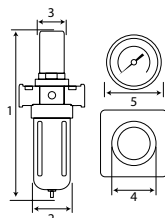

- Case material poly carbonate
- High pressure (Maximum Pressure 10Kgf/cm²)
- High temperature (5-60°C or 40-140°F)
- Easy for installation
- Suitable for Limited Space Application
- Drain Release Automatically When Water Accumulation is less than 1 KG

AIR CONTROL UNIT DOUBLE

SARINGAN UDARA 2 TABUNG



ITEM CODE	SIZE	1 (mm)	2 (mm)	3 (mm)	4 (mm)	5 (mm)	AIR INLET (inch)	WEIGHT (gr)	QTY / BOX INNER/MASTER
AT-AC1703	3/4"	214	49	32	170	50	3/4	1,040	1 / 10 pcs

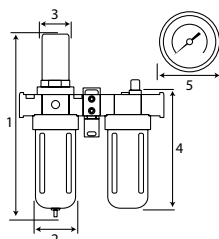

- Case material poly carbonate
- High pressure (Maximum Pressure 10Kgf/cm²)
- High temperature (5-60°C or 40-140°F)
- Easy for installation
- Suitable for Limited Space Application
- Drain Release Automatically When Water Accumulation is less than 1KG

MINI AIR CONTROL UNIT SINGLE

SARINGAN UDARA 1 TABUNG MINI



ITEM CODE	SIZE	1 (mm)	2 (mm)	3 (mm)	4 (mm)	5 (mm)	AIR INLET (inch)	WEIGHT (gr)	QTY / BOX INNER/MASTER
AT-AC1704	1/4"	150	30	26	29	40	1/4	264	1 / 50 pcs

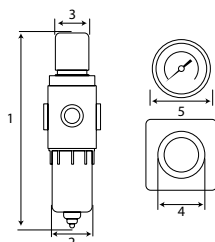

- Case material poly carbonate
- High pressure (Maximum Pressure 10Kgf/cm²)
- High temperature (5-60°C or 40-140°F)
- Easy for installation
- Suitable for Limited Space Application
- Drain Release Automatically When Water Accumulation is less than 1KG

MINI AIR CONTROL UNIT DOUBLE

SARINGAN UDARA 2 TABUNG MINI



ITEM CODE	SIZE	1 (mm)	2 (mm)	3 (mm)	4 (mm)	5 (mm)	AIR INLET (inch)	WEIGHT (gr)	QTY / BOX INNER/MASTER
AT-AC1705	1/4"	148	30	25	128	40	1/4	365	1 / 50 pcs

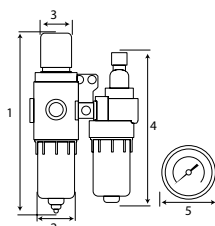

- Case material poly carbonate
- High pressure (Maximum Pressure 10Kgf/cm²)
- High temperature (5-60°C or 40-140°F)
- Easy for installation
- Suitable for Limited Space Application
- Drain Release Automatically When Water Accumulation is less than 1KG

AIR TOOLS

AIR IMPACT WRENCH

Designed and engineered to work hard, our air impact wrenches handle the toughest jobs, offering outstanding value. Industrial professionals will be able to release wheel nuts quickly and easily with our versatile impact wrenches; our impact wrenches are feature-packed, giving you the power and torque you need to easily do your job.



TEKIRO AIR IMPACT WRENCH

Built to deliver outstanding performance in any job. With several product lines and a range of different potential configurations, it's easy to find the right tool for the task. All our products feature an industry-leading combination of performance, ergonomics and durability — everything you need to boost production and keep your team working more efficiently all-day long.

GO TOUGH AND RUGGED

Designed to withstand tough use in rugged environments, this impact wrench offers greater

DIFFERENT SPEED SETTINGS

Available in multiple speeds for each forward and reverse direction, our impact wrench range offers torque outputs to 650 n/m. Alloy steel, heat treated, helical gears for maximum durability.

AIR TOOLS

TEKIRO ALL AIR IMPACT TECHNOLOGY

AIR IMPACT

- Comfort over long periods of use
- Twin clutch with high
- Performance clutch - longer life under tough condition
- Ergonomic handle exhaust keeps exhaust air away from the operator



PIN CLUTCH HAMMER MECHANISM

- Two Pin Clutch hammers strike the anvil, provides high torque, low vibration and fast run downs.
- The mechanism delivers higher performance and extended durability
- For automotive service work and better for assembly lines



AIR IMPACT WRENCH JUMBO HAMMER

- High torque air impact
- Comfort over long periods of use
- Performance clutch - longer life under tough condition
- Ergonomic handle exhaust keeps exhaust air away from the operator
- High Speed 10.000 Rpm



JUMBO HAMMER MECHANISM

- Same mechanism as Twin Hammer but with one hammer only. It delivers an instantaneous, balanced blow, with excellent impacting power



AIR TOOLS TEKIRO ALL AIR IMPACT TECHNOLOGY

ANVIL AIR IMPACT

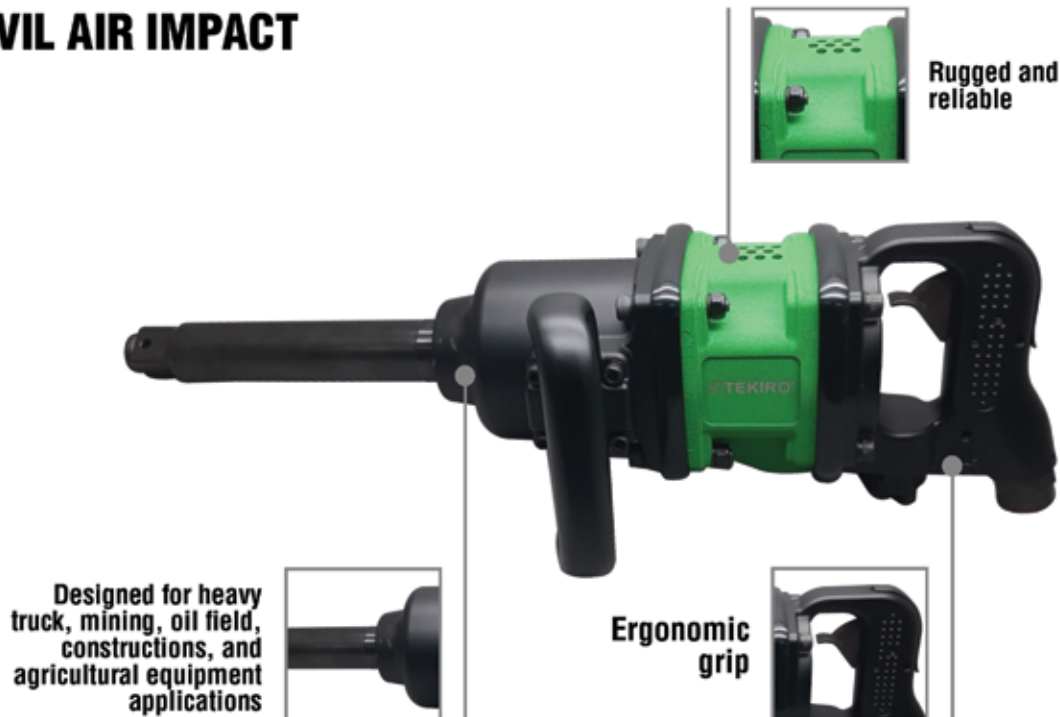

ANVIL TWIN HAMMER

- High torque air impact
- Comfort over long periods of use
- Performance clutch - longer life under tough condition
- Ergonomic handle exhaust keeps exhaust air away from the operator
- High Speed 8.000 Rpm
- Two hammers make one impact per rotation.
- This design is the most durable of hammer designs and lighter, less vibration, producing a powerful impact

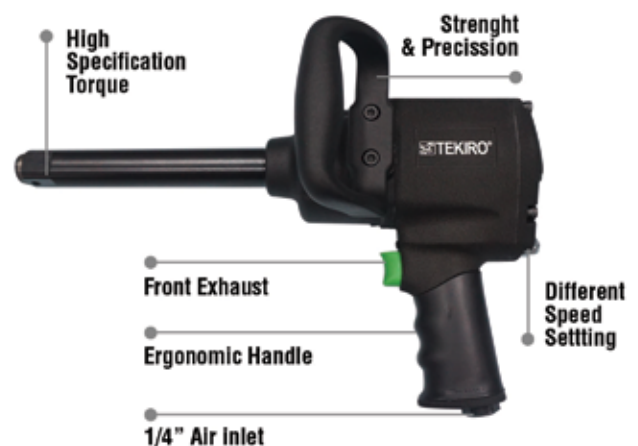

TWIN HAMMER MECHANISM

- High torque when starting with good continuity
- Endurable impact with consistent torque for long time work
- Constructed with precision components and impact mechanism
- One cycle, two hammers
- More powerful than any other mechanism on the market



- 370 - 800 Ft. Lbs. of Torque - power to loosen the toughest fastener
- Comfort over long periods of use
- Twin clutch with high performance clutch - longer life under tough conditions
- Ergonomic handle exhaust keeps exhaust air away from the operator

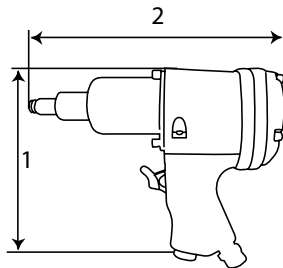

HEAVY DUTY IMPACT WRENCH

ALAT PEMBUKA BAUT TENAGA ANGIN

SPEC	1/2"	3/4"
ITEM CODE	AT-AI1126	AT-AI1127
SPEED (RPM)	7000	4700
BOLT CAPACITY	3/4"	1"
SQUARE DRIVER	1/2"	3/4"
MAX TORQUE (LBS)	370	800
AIR PRESS. (Psi)	90	90
AIR INLET (NPT)	1/4"	1/4"
HOSE SIZE (ID)	3/8"	3/8"
AIR CONS. (CFM)	4	5
OVERALL LENGTH	7 9/16"	9 3/4"
QTY / BOX (INNER / MASTER)	1 / 10 pcs	1 / 4 pcs
1 (mm)	189	231
2 (mm)	197	246
WEIGHT (gr)	2,600	4,910

- High Specification Torque
- Handle Exhaust
- Not slippery when used
- Strength and Precision Drive

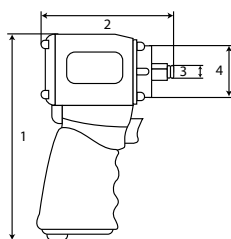

1/2" AIR IMPACT WRENCH JUMBO HAMMER

1/2" DR. ALAT PEMBUKA BAUT TENAGA ANGIN JUMBO HAMMER

SPEC	1/2"
ITEM CODE	AT-AI1668
SPEED (RPM)	10,000
BOLT CAPACITY	M16 (24mm)
SQUARE DRIVER	1/2"
MAX TORQUE (Nm)	678
AIR CONS. (m³/min)	0.22
AIR INLET (NPT)	1/4"
HOSE SIZE (mm)	10mm
SOUND PRESSURE (dBA)	94
VIBRATION (m/s²)	2.8
QTY / BOX (INNER / MASTER)	1 / 10 pcs
1 (mm)	190
2 (mm)	99
3 (mm)	13
4 (mm)	51
WEIGHT (gr)	1,520

1/2" AIR IMPACT WRENCH TWIN HAMMER

1/2" DR. ALAT PEMBUKA BAUT TENAGA ANGIN TWIN HAMMER

SPEC	1/2"
ITEM CODE	AT-AI1669
SPEED (RPM)	8,000
BOLT CAPACITY	M18 (27mm)
SQUARE DRIVER	1/2"
MAX TORQUE (Nm)	610
AIR CONS. (m³/min)	0.22
AIR INLET (NPT)	1/4"
HOSE SIZE (mm)	10 mm
SOUND PRESSURE (dBA)	98
VIBRATION (m/s²)	4.6
QTY / BOX (INNER / MASTER)	1 / 6 pcs
1 (mm)	185
2 (mm)	189
3 (mm)	12
4 (mm)	62
WEIGHT (gr)	2,910

- High Specification Torque
- Front Exhaust
- Not slippery when used
- Strength and Precision Drive

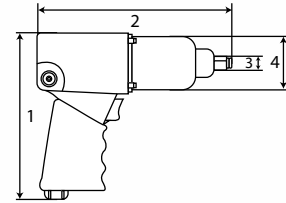

3/4" AIR IMPACT WRENCH TWIN HAMMER

3/4" DR. ALAT PEMBUKA BAUT TENAGA ANGIN TWIN HAMMER

SPEC	3/4"
ITEM CODE	AT-AI1727
SPEED (RPM)	6,000
BOLT CAPACITY	36mm
SQUARE DRIVER	3/4"
MAX TORQUE (Nm)	1,491
AIR CONS. (m³/min)	0.32
AIR INLET (NPT)	1/4"
HOSE SIZE (mm)	10 mm
SOUND PRESSURE (dBA)	94
VIBRATION (m/s²)	5.3
QTY / BOX (INNER / MASTER)	1 / 4 pcs
1 (mm)	205
2 (mm)	205
3 (mm)	18
4 (mm)	69
WEIGHT (gr)	4,200

- High Specification Torque
- Front Exhaust
- Not slippery when used
- Strength and Precision Drive

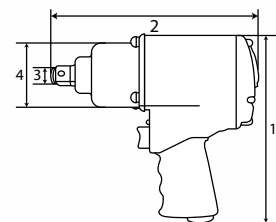

AUTOMOTIVE

STORAGE

TRAY

AIR TOOLS

HEX KEY

GENERAL TOOLS

- High Specification Torque
- Front Exhaust
- Not slippery when used
- Strength and Precision Drive

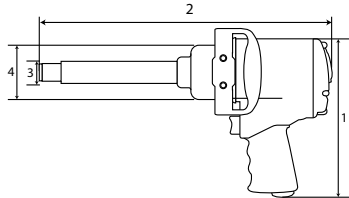

1" AIR IMPACT WRENCH TWIN HAMMER

1" DR. ALAT PEMBUKA BAUT TENAGA ANGIN TWIN HAMMER

SPEC	1"
ITEM CODE	AT-AI1728
SPEED (RPM)	4500
BOLT CAPACITY	38 mm
SQUARE DRIVER	1"
MAX TORQUE (Nm)	2,440
AIR CONS. (m³/min)	0.32
AIR INLET (NPT)	3/8"
HOSE SIZE (mm)	10 mm
SOUND PRESSURE (dBA)	97
VIBRATION (m/s²)	6.1
QTY / BOX (INNER / MASTER)	1 / 2 pcs
1 (mm)	225
2 (mm)	400
3 (mm)	25
4 (mm)	85
WEIGHT (gr)	6,700

- High Specification Torque
- Front Exhaust
- Not slippery when used
- Strength and Precision Drive

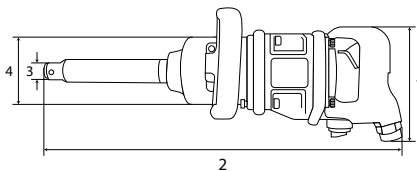

1" AIR IMPACT WRENCH ANVIL TWIN HAMMER

1" DR. ALAT PEMBUKA BAUT TENAGA ANGIN ANVIL TWIN HAMMER

SPEC	1"
ITEM CODE	AT-AI1897
SPEED (RPM)	3,600
BOLT CAPACITY	M42 (65mm)
SQUARE DRIVER	1"
MAX TORQUE (Nm)	2,200 ft-lb @15Sec 2,982 Nm @15Sec
AIR CONS. (m³/min)	0.31
AIR INLET (NPT)	1/2"
HOSE SIZE (inch)	1/2"
SOUND PRESSURE (dBA)	101.5
VIBRATION (m/s²)	
QTY / BOX (INNER / MASTER)	1 / 2 pcs
1 (mm)	172
2 (mm)	580
3 (mm)	25
4 (mm)	105
WEIGHT (gr)	15,000

Note: Tekiro's warranty applied for Indonesia market only

AIR IMPACT TWIN HAMMER 1/2" 12 PC

1/2" DR. ALAT PEMBUKA BAUT TENAGA ANGIN SET 12 PCS TWIN HAMMER

- High Specification Torque 450 ft. lbs
- Front Exhaust
- Twin Hammer mechanism

ITEM CODE	CONTENT	WEIGHT (gr)	QTY / BOX INNER/MASTER
AT-AI1733	1/2" Air Impact Wrench Twin Hammer	5,685	1 / 4 set
	1/2" DR. Deep Impact Socket 6PT 10 mm		
	1/2" DR. Deep Impact Socket 6PT 12 mm		
	1/2" DR. Deep Impact Socket 6PT 14 mm		
	1/2" DR. Deep Impact Socket 6PT 17 mm		
	1/2" DR. Deep Impact Socket 6PT 19 mm		
	1/2" DR. Deep Impact Socket 6PT 21 mm		
	1/2" DR. Deep Impact Socket 6PT 23 mm		
	1/2" DR. Deep Impact Socket 6PT 24 mm		
	Mini Oiler		
	Oil Pot		
	Coupler		



AIR IMPACT JUMBO WITH STUBBY IMPACT SOCKET SET 12 PCS

1/2" DR. ALAT PEMBUKA BAUT TENAGA ANGIN SET 12 PCS JUMBO

- High Specification Torque 500 ft. lbs
- Handle Exhaust
- Jumbo Hammer mechanism

ITEM CODE	CONTENT	WEIGHT (gr)	QTY / BOX INNER/MASTER
AT-AI1750	Impact Socket 1/2" 6 PT	1,596	1 / 6 set
	Coupler		
	Air Filter		
	Mini Oiler		



AUTOMOTIVE

STORAGE

TRAY

AIR TOOLS

HEX KEY

GENERAL TOOLS

- High Torque
- Right and left switch
- Side exhaust
- Durable aluminum housing



AIR RATCHET WRENCH

KUNCI RATCHET TENAGA ANGIN

ITEM CODE	SIZE	1 (mm)	2 (mm)	3 (mm)	4 (mm)	5 (mm)	WEIGHT (gr)	QTY / BOX INNER/MASTER
AT-AR1797	3/8"	263	25	8	19	26	1,170	1 / 20 pcs
AT-AR1798	1/2"	263	25	12	19	27	1,170	1 / 20 pcs

SPECIFICATION	SIZE	
	3/8"	1/2"
Square Driver	3/8"	1/2"
Free Speed	150RPM	150RPM
Max. Torque	50ft-lbs	50ft-lbs
Air Inlet	1/4"	1/4"
Air Pressure	90psi	90psi
Air Consumption	4CFM	4CFM

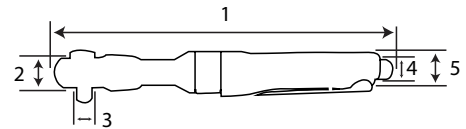

- High quality Plastic
- High purity filter
- Aluminum cover for extra strength



OIL AIR FILTER 1/4"

1/4" SARINGAN UDARA

ITEM CODE	SIZE	1 (mm)	2 (mm)	3 (mm)	4 (mm)	WEIGHT (gr)	QTY / BOX INNER/MASTER
AT-OA1870	1/4"	86.5	13	39	11.5	1,100	10 / 100 pcs

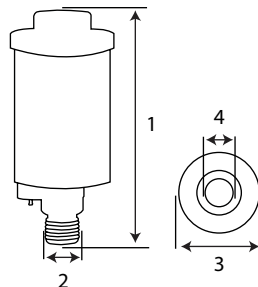

- Low vibration for swirlmark-free finishes
- Durable, Lightweight composite housing design
- Low profile balanced sanding pad

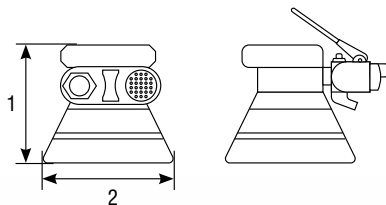

NON-VACUUM ORBITAL SANDER

ALAT AMPLAS TENAGA ANGIN

SPEC		
ITEM CODE	AT-OS1873	AT-OS1874
SPEC (Diameter Pad)	5"	6"
SPEED (RPM)	11,000	11,000
Diameter Orbit (mm)	5	5
Noise Level (dBA)	80	80
Vibration (m/s ²)	0.8	0.8
Air Inlet (Inch)	1/4	1/4
Min. Hose Size (Inch / mm)	3/8 (10)	3/8 (10)
Average Air Consumption (CFM)	1.6	1.6
1 (mm)	122	148
2 (mm)	93	94
WEIGHT (gr)	780	810
Qty / Box Inner / Master	1 / 10	1 / 10

BELIEVE
IN YOUR CHOICE

WWW.TEKIRO.COM