



**MEASUREMENT**





### TAPE MEASURE TRANSPARENT

Slim model with a high impact case made of ABS plastic. Yellow, wear resistant blade using painting coated, smooth blade return action and bump stop with anti-wear function

Superior internal mechanism provides smooth operation

Fast lock for quick and easy blade control



Hinge Rack for ease storage

High impact case made of ABS Plastic

With high accurate end-hook

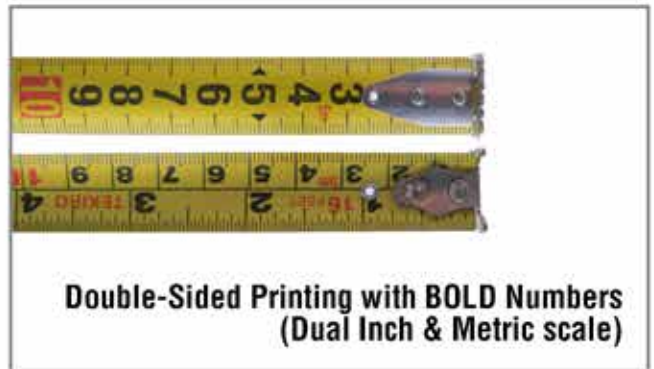

Double-Sided Printing with BOLD Numbers (Dual Inch & Metric scale)

### TAPE MEASURE 5 M FENG SHUI

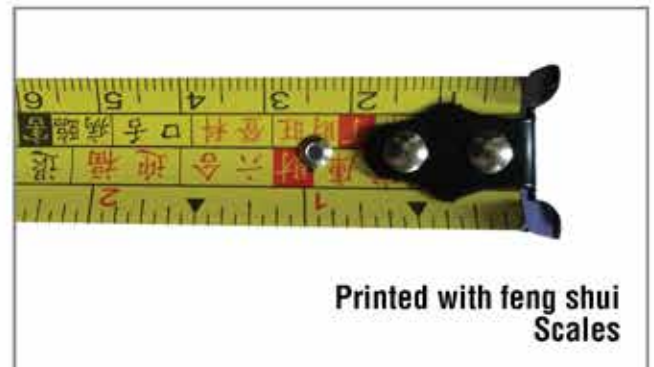

Printed with feng shui Scales

## TAPE MEASURE TRANSPARENT

METERAN TRANSPARAN

ITEM CODE	SIZE	1 (mm)	2 (mm)	WEIGHT (gr)	QTY / BOX INNER/MASTER
GT-MT1718	3 m	61	29	141	12 / 120 pcs
GT-MT1719	5 m	70	32	238	12 / 60 pcs
GT-MT1720	7,5 m	80	38	408	6 / 60 pcs
GT-MT1721	10 m	85	39	531	6 / 60 pcs

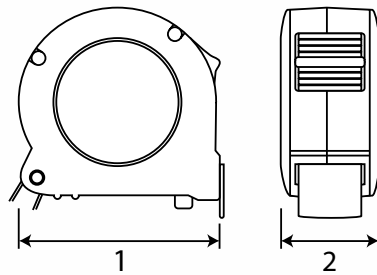

- High impact ABS plastic
- Power-return tape for easy operation
- Dual-end hook holds blade firmly
- Dual inch/metric scale for any job
- Painting coated blade

## TAPE MEASURE 5 M FENG SHUI

METERAN FENG SHUI 5 M

ITEM CODE	SIZE	1 (mm)	2 (mm)	3 (mm)	WEIGHT (gr)	QTY / BOX INNER/MASTER
GT-MT1822	5 m	66	30	19	176	12 / 120 pcs

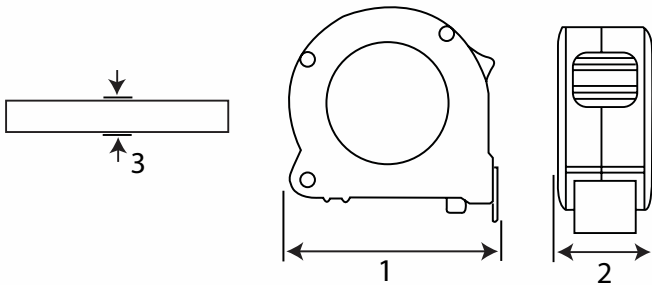

- High impact ABS plastic
- Power-return tape for easy operation
- Dual-end hook holds blade firmly
- Dual inch/metric scale for any job
- Painting coated blade

## TESTING MANIFOLD

TESTING MANIFOLD REGULATOR FREON

ITEM CODE	SIZE	1 (mm)	2 (mm)	3 (mm)	4 (mm)	5 (mm)	6 (mm)	7 (mm)	8 (mm)	9 (mm)	WEIGHT (gr)	QTY / BOX INNER/MASTER
GT-TM1875	600 psi	73	73	11	11	11	175	17	17	17	1,562	1 / 16

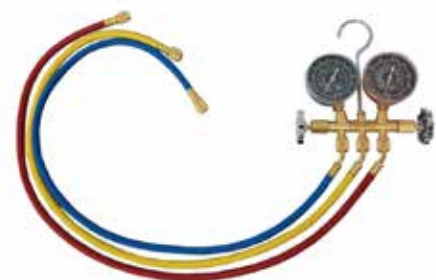
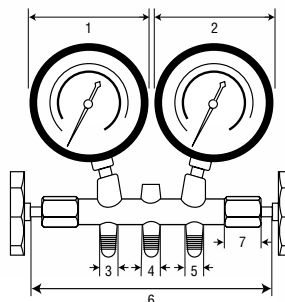
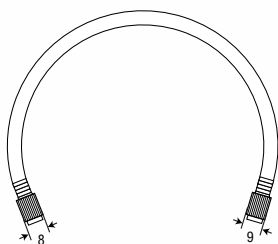

- Solid Brass and seamless manifold body for R-12 & R-134a
- Blue Gauge (Low) : 0-350 Psi & Red Gauge (High) : 0-500 Psi
- 36" Hose, Working Pressure : 600 Psi and Burst Pressure : 3,000 Psi

- CAT III, Overload Protection
- Low battery Indication
- Data Hold Function
- polarity Indication
- Auto Range
- Zeroing Function
- Automatic - Power Off



## DIGITAL CLAMP METER

### TANG AMPERE

ITEM CODE	MS-DC1905
DISPLAY	3 1/2 digit LCD, with a max. reading of 1999
OVER-RANGE INDICATION	OL shown on the display
NEGATIVE POLARITY INDICATION	Negative sign "-" shown on the display automatically
SAMPLING RATE	Approximate 3 times per sec
ERROR CAUSED BY IMPROPER POSITION	1% of reading
TJAW OPENING CAPACITY	25mm
MAX. MEASUREABLE CONDUCTOR	ø25mm
BATTERY	3V CR2032 button cells, 2 pieces
LOW BATTERY INDICATION	shown on the display
OPERATING ENVIRONMENT	Temperature: 0°C to 40°C
RELATIVE HUMIDITY	< 75%
STORAGE ENVIRONMENT	Temperature: -20°C to 50°C
RELATIVE HUMIDITY	< 85%RH
QTY / BOX (INNER / MASTER)	1 / 24
SIZE	190x76x36mm
WEIGHT	About 160g (including button cells)

- Troubleshoot Problems : Effectively capture voltage and frequency measurements and troubleshoot electrical problems
- Compact Size : Ideal for residential and automotive needs, the multimeter features a compact size that fits into your pocket or toolbelt for easy access.



## COMPACT DIGITAL MULTIMETER

### COMPACT DIGITAL MULTIMETER

ITEM CODE	MS-DM1906
DISPLAY	3 1/2 digit LCD, with a max. reading of 1999
NEGATIVE POLARITY INDICATION	Negative sign "-" shown on the display automatically
SAMPLING RATE	About 2 to 3 times/sec
OPERATING ENVIRONMENT	Temperature: 0°C to 50°C
RELATIVE HUMIDITY	< 75%
TEMPERATURE COEFFICIENT	0.2 x (specified accuracy)/°C (< 18°C or > 28°C)
STORAGE ENVIRONMENT	Temperature: -10°C to 60°C
RELATIVE HUMIDITY	< 85%RH
IP DEGREE	IP20
BATTERY	9V battery, 6F22 or equivalent, 1 piece
LOW BATTERY INDICATION	" " shown on the display
SIZE	144x80x38mm
QTY / BOX (INNER / MASTER)	1 / 54
WEIGHT (gr)	About 203g (including battery)

## DIGITAL MULTIMETER

### DIGITAL MULTIMETER

ITEM CODE	MS-DM1907
DISPLAY	3 1/2 digit LCD, with a max. reading of 1999
NEGATIVE POLARITY INDICATION	Negative sign "-" shown on the display automatically
SAMPLING RATE	About 2 to 3 times/sec
OPERATING ENVIRONMENT	Temperature: 0°C to 40°C
RELATIVE HUMIDITY	< 75%
TEMPERATURE COEFFICIENT	0.2 x (specified accuracy)/°C (< 18°C or > 28°C)
STORAGE ENVIRONMENT	Temperature: -10°C to 50°C
RELATIVE HUMIDITY	< 85%RH
OPERATING ALTITUDE	0 to 2000 meters
IP DEGREE	IP20
BATTERY	Vbattery, 6F22 or equivalent, 1 piece
LOW BATTERY INDICATION	" " shown on the display
SIZE	144x80x38mm
QTY / BOX (INNER / MASTER)	1 / 36
WEIGHT (gr)	About 214g (including battery)

- Squarewave output
- Data Hold
- polarity Indication
- Overrange Indication
- Overload protection
- Automatic - Power Off 15 min



## TRUE RMS DIGITAL MULTIMETER

### TRUE RMS DIGITAL MULTIMETER

ITEM CODE	MS-DM1908
FUSE PROTECTION FOR "INPUT" TERMINAL INPUTS	400mA/600V FAST fuse
FUSE PROTECTION FOR "10A" TERMINAL INPUTS	10A/600V FAST fuse
DISPLAY	3 3/4 digit LCD, with a max. reading of 3999
OVERRANGE INDICATION	OL shown on the display.
NEGATIVE POLARITY INDICATION	Negative sign "-" shown on the display automatically
SAMPLING RATE	About 2 to 3 times/sec
IP DEGREE	IP20
OPERATING ENVIRONMENT	Temperature: 0°C to 40°C
RELATIVE HUMIDITY	< 75%
TEMPERATURE COEFFICIENT	0.2 x (specified accuracy)/°C (< 18°C or > 28°C)
STORAGE ENVIRONMENT: TEMPERATURE	-10°C to 50°C
RELATIVE HUMIDITY	< 85%RH
OPERATING ALTITUDE	0 to 2000 meters
BATTERY	9V battery, 6F22 or equivalent, 1 piece
LOW BATTERY INDICATION	" " shown on the display
SIZE	185x89x61mm
QTY / BOX (INNER / MASTER)	1 / 20
WEIGHT	About 440g (including battery)

- TRUE RMS measurement for AC Voltage, AC Current Functions
- AUTORANGING : the meter defaults to autorange mode in measurement functions which have both autorange mode and manual range mode. when the meter in autorange mode, the symbol "AUTO" is displayed
- AUTO Power OFF: the display will blank and the meter will go sleep mode if you have not turned the function switch or pressed a button for about 15 minutes
- Built-in Non-Contact Voltage (NCV) Detector allows for quick detection of AC voltage





**BELIEVE**  
**IN YOUR CHOICE**

**WWW.TEKIRO.COM**